

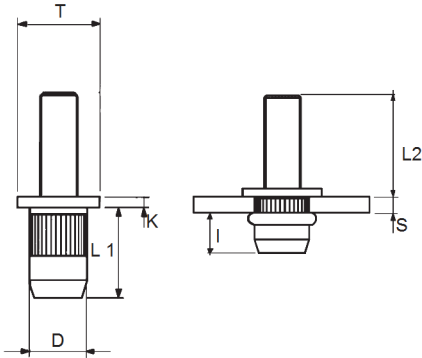



ACCIAIO Z. B. CROMO III
 STEEL ZINC PLATED Cr III
 STAHL VERZINKT Cr III
 ACIER ZINGUÉ Cr III
 ACERO CINCADO Cr III

ITTM

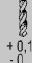

CODICE CODE		S	D <small>+0,07 - 0,1</small>	 <small>+0,1 -0</small>	T <small>+/- 0,3</small>	K <small>+/- 0,15</small>	L1	L2	I ~	 Nm
85ACITMM0410C 85ACITMM0410L 85ACITMM0415C 85ACITMM0415L	M4	0,5 - 2,0 2,0 - 3,0 0,5 - 2,0 2,0 - 3,0	5,4	5,5	8	0,8	8	10 10 15 15	3,5 4 3,5 4	5
85ACITMM0515C 85ACITMM0520C 85ACITMM0525C	M5	0,5 - 3,0 0,5 - 3,0 0,5 - 3,0	6,9	7	10	1	12	15 20 25	- 6-7 -	7
85ACITMM0615C 85ACITMM0620C 85ACITMM0625C	M6	0,5 - 3,0	8,9	9	13	1,5	14,5	15 20 25	8-9	10
85ACITMM0820C 85ACITMM0825C	M8	0,5 - 3,0	10,9	11	16	1,5	15,5	20 25	9-10 -	30

ITTEM

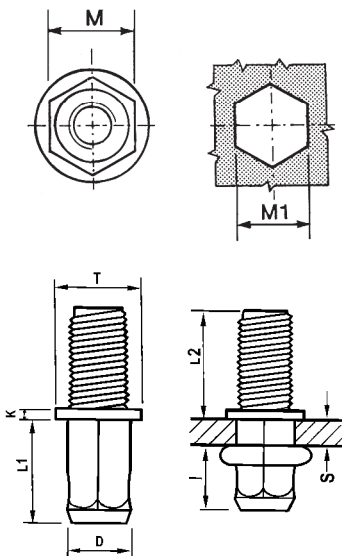

85ACITTEM0525C 85ACITTEM0530C 85ACITTEM0535C	M5	0,5 - 3,0	6,9	7	10	1	12	25 30 35	5-5,5	7
85ACITTEM0615C 85ACITTEM0620C 85ACITTEM0625C	M6	0,5 - 3,0	8,9	9	13	1,5	14,5	15 20 25	7-7,5	10
85ACITTEM0820C 85ACITTEM0825C	M8	0,5 - 3,0	10,9	11	16	1,5	15,5	20 25	8-8,5	30