



PLASTOMET

280







> Wing screws / nuts BPF 10 Page **284 - 285**



> Wing screws / nuts BPF 20 Page **286 - 287**



> Wing screws / nuts BPF 30 Page **288 - 289**



> Wing screws / nuts BPF 50 Page **290 - 291**



> Wing screws / nuts BPF 55 Page **292 - 293**



> Wing screws / nuts BPF 60 Page **294 - 295**



> Four-stars screws / nuts BPF 70 Page **296 - 297**



> Knurled thumb screws BPF 80 / BPF 83 Page **298 - 299**



> Knurled thumb screws BPF 82 / BPF 86 Page **300 - 301**



> Knurled nuts BPF 84 / BPF 85 / BPF 105 Page **302 - 303**



> Knurled screws / nuts BPF 90 Page **304 - 305**



> Knurled screws / nuts BPF 100 Page **306 - 307**



> Conical knurled screws BPF 110 Page **308 - 309**



> Binder posts BPF 120 Page **310 - 311**



> Knurled screws / nuts BPF 130 Page **312 - 313**



> Wing screws / nuts BPF 150 Page **314 - 315**



> Washer faced hex head screws BPF 180 Page **316 - 317**



> Hex cap nuts BPF 181 / BPF 183 Page **318 - 319**



> Washer faced hex head slotted screws BPF 182 Page **320 - 321**



> Knurled nuts BPF 196/ BPF 197 Page **322 - 323**



> Plastomet adjustable feet Page **324 - 325**



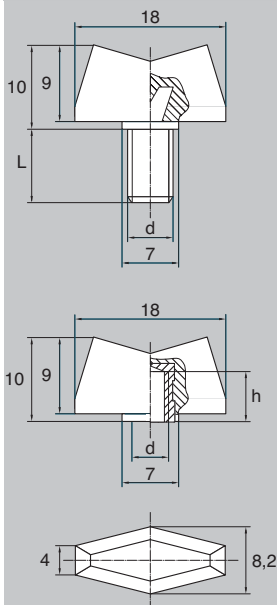

Screw

d	L	Unit of sale	Part N° (Zinc-plated steel)
M3	8	2 500	BPF1038Baz
M3	10	2 500	BPF10310Baz
M3	12	2 500	BPF10312Baz
M3	16	2 500	BPF10316Baz
M3	18	2 500	BPF10318Baz
M3	20	2 500	BPF10320Baz
M3	30	2 500	BPF10330Baz
M3	40	2 500	BPF10340Baz
M4	8	2 500	BPF1048Baz
M4	10	2 500	BPF10410Baz
M4	12	2 500	BPF10412Baz
M4	16	2 500	BPF10416Baz
M4	18	2 500	BPF10418Baz
M4	20	2 500	BPF10420Baz
M4	25	2 500	BPF10425Baz
M4	30	2 500	BPF10430Baz
M4	40	2 500	BPF10440Baz

> Other lengths on request.

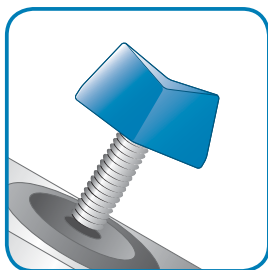

Nut

d	h	Unit of sale	Type	Part N° (Brass)
M3	4,5	1 000	Closed	BPF103Bmsf

MATERIALS - COLOURS

Screw

STANDARD :

- Head : black Nylon - Insert : zinc-plated steel.

ON REQUEST :

- Head colours : see RAL colour chart page 510 / 511.
- Insert : stainless steel or brass.

Nut

STANDARD :

- Head : black Nylon - Insert : brass.

ON REQUEST :

- Head colours : see RAL colour chart page 510 / 511.
- Insert : stainless steel.



Black Nylon



White Nylon



Red Nylon



Blue Nylon



Yellow Nylon



Grey Nylon

> This screw type in full Nylon (M5, M6, M8 x ...) : see page



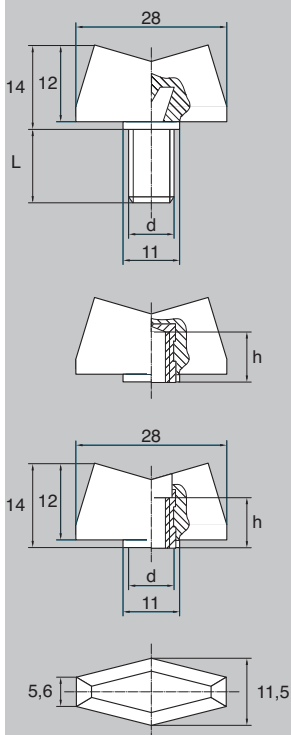

Screw

d	L	Unit of sale	Part N° (Zinc-plated steel)
M4	8	2 500	BPF2048Baz
M4	10	2 500	BPF20410Baz
M4	12	2 500	BPF20412Baz
M4	15/16	2 500	BPF20416Baz
M4	18	2 500	BPF20418Baz
M4	20	2 500	BPF20420Baz
M4	25	2 500	BPF20425Baz
M4	30	2 500	BPF20430Baz
M5	10	2 500	BPF20510Baz
M5	12	2 500	BPF20512Baz
M5	15/16	2 500	BPF20516Baz
M5	18	2 500	BPF20518Baz
M5	20	2 500	BPF20520Baz
M5	25	2 500	BPF20525Baz
M5	30	2 500	BPF20530Baz
M5	35	2 500	BPF20535Baz
M5	40	2 500	BPF20540Baz
M6	10	1 000	BPF20610Baz
M6	12	2 500	BPF20612Baz
M6	15/16	1 000	BPF20616Baz
M6	18	2 500	BPF20618Baz
M6	20	1 000	BPF20620Baz
M6	25	2 500	BPF20625Baz
M6	30	2 500	BPF20630Baz
M6	35	2 500	BPF20635Baz
M6	40	2 500	BPF20640Baz
M6	50	2 500	BPF20650Baz

286



Nut

d	h	Unit of sale	Type	Part N° (Brass)
M4	6	1 000	Closed	BPF204Bmsf
M5	7,5	1 000	Closed	BPF205Bmsf
M5	7,5	1 000	Open	BPF205Bmso
M6	8,5	1 000	Open	BPF206Bmso

MATERIALS - COLOURS

Screw

STANDARD :

- Head : black Nylon - Insert : zinc-plated steel.

ON REQUEST :

- Head colours : see RAL colour chart page 510 / 511.
- Insert : stainless steel or brass.

Nut

STANDARD :

- Head : black Nylon - Insert : brass.

ON REQUEST :

- Head colours : see RAL colour chart page 510 / 511.
- Insert : stainless steel.

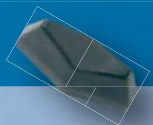
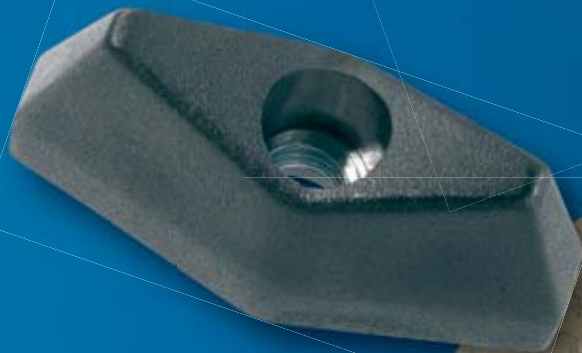

Black Nylon



White Nylon



Red Nylon



Blue Nylon



Yellow Nylon



Grey Nylon

> This screw type in full Nylon (M5, M6, M8, M10 x ...) : see page 192.



PLASTOMET > Wing screws / nuts BPF 30

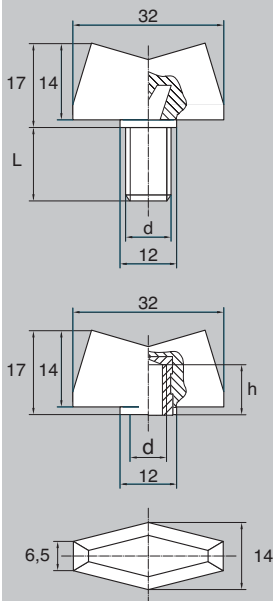

Screw

d	L	Unit of sale	Part N° (Zinc-plated steel)
M6	8	5 000	BPF3068Baz
M6	10	5 000	BPF30610Baz
M6	12	5 000	BPF30612Baz
M6	16	5 000	BPF30616Baz
M6	18	5 000	BPF30618Baz
M6	20	5 000	BPF30620Baz
M6	25	5 000	BPF30625Baz
M6	30	5 000	BPF30630Baz
M6	35	5 000	BPF30635Baz
M6	40	5 000	BPF30640Baz
M6	45	5 000	BPF30645Baz
M6	50	5 000	BPF30650Baz
M8	16	5 000	BPF30816Baz
M8	18	5 000	BPF30818Baz
M8	20	5 000	BPF30820Baz
M8	25	5 000	BPF30825Baz
M8	30	5 000	BPF30830Baz
M8	35	5 000	BPF30835Baz
M8	40	5 000	BPF30840Baz
M8	45	5 000	BPF30845Baz
M8	50	5 000	BPF30850Baz
M8	60	5 000	BPF30860Baz

288

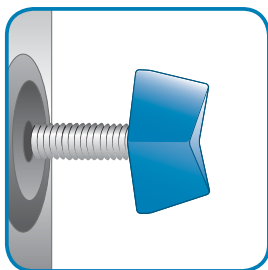

Nut

d	h	Unit of sale	Type	Part N° (Brass)
M6	8	1 000	Closed	BPF306Bmsf

MATERIALS - COLOURS

Screw

STANDARD :

- Head : black Nylon - Insert : zinc-plated steel.

ON REQUEST :

- Head colours : see RAL colour chart page 510 / 511.
- Insert : stainless steel or brass.

Nut

STANDARD :

- Head : black Nylon - Insert : brass.

ON REQUEST :

- Head colours : see RAL colour chart page 510 / 511.
- Insert : stainless steel.



289



Black Nylon



White Nylon



Red Nylon



Blue Nylon



Yellow Nylon



Grey Nylon

> This screw type in full Nylon (M6, M8, M10, M12 x ...) : see page 194.



PLASTOMET > Wing screws / nuts BPF 50

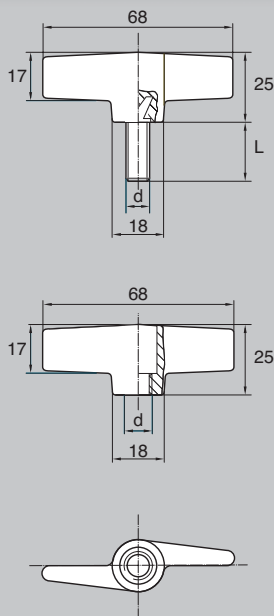

Screw

d	L	Unit of sale	Part N° (Zinc-plated steel)
M6	10	5 000	BPF50610Baz
M6	12	5 000	BPF50612Baz
M6	16	5 000	BPF50616Baz
M6	18	5 000	BPF50618Baz
M6	20	5 000	BPF50620Baz
M6	25	5 000	BPF50625Baz
M6	30	5 000	BPF50630Baz
M6	35	5 000	BPF50635Baz
M6	40	5 000	BPF50640Baz
M6	45	5 000	BPF50645Baz
M6	50	5 000	BPF50650Baz
M8	16	5 000	BPF50816Baz
M8	18	5 000	BPF50818Baz
M8	20	5 000	BPF50820Baz
M8	25	5 000	BPF50825Baz
M8	30	5 000	BPF50830Baz
M8	35	5 000	BPF50835Baz
M8	40	5 000	BPF50840Baz
M8	45	5 000	BPF50845Baz
M8	50	5 000	BPF50850Baz
M10	ON REQUEST		

> Optional cover
(part N° 42200) : page 231.



Nut

d	Unit of sale	Type	Part N° (Zinc-plated steel)
M6	500	Open	BPF506Baz
M8	500	Open	BPF508Baz
M10	ON REQUEST		

MATERIALS - COLOURS

Screw

STANDARD :

- Head : black Nylon - Insert : zinc-plated steel.

ON REQUEST :

- Head colours : see RAL colour chart page 510 / 511.
- Insert : stainless steel or brass.

Nut

STANDARD :

- Head : black Nylon - Insert : zinc-plated steel.

ON REQUEST :

- Head colours : see RAL colour chart page 510 / 511.
- Insert : stainless steel or brass.



291



Black Nylon



White Nylon

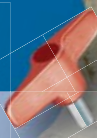

Red Nylon



Blue Nylon



Yellow Nylon



Grey Nylon



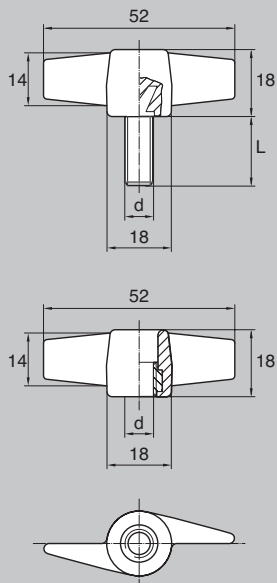

Screw

d	L	Unit of sale	Part N° (Zinc-plated steel)
M6	10	5 000	BPF55610Baz
M6	12	5 000	BPF55612Baz
M6	16	5 000	BPF55616Baz
M6	18	5 000	BPF55618Baz
M6	20	5 000	BPF55620Baz
M6	25	5 000	BPF55625Baz
M6	30	5 000	BPF55630Baz
M6	35	5 000	BPF55635Baz
M6	40	5 000	BPF55640Baz
M6	45	5 000	BPF55645Baz
M6	50	5 000	BPF55650Baz
M8	16	5 000	BPF55816Baz
M8	18	5 000	BPF55818Baz
M8	20	5 000	BPF55820Baz
M8	25	5 000	BPF55825Baz
M8	30	5 000	BPF55830Baz
M8	35	5 000	BPF55835Baz
M8	40	5 000	BPF55840Baz
M8	45	5 000	BPF55845Baz
M8	50	5 000	BPF55850Baz

Nut

d	Unit of sale	Type	Part N° (Zinc-plated steel)
M6	5 000	Open	BPF556Baz
M8	5 000	Open	BPF558Baz

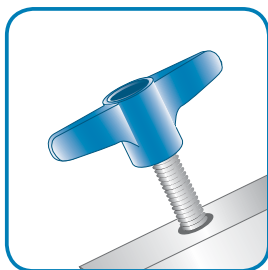

MATERIALS - COLOURS

Screw

STANDARD :

- Head : black Nylon - Insert : zinc-plated steel.

ON REQUEST :

- Head colours : see RAL colour chart page 510 / 511.
- Insert : stainless steel or brass.

Nut

STANDARD :

- Head : black Nylon - Insert : zinc-plated steel.

ON REQUEST :

- Head colours : see RAL colour chart page 510 / 511.
- Insert : stainless steel or brass.



Black Nylon



White Nylon



Red Nylon



Blue Nylon



Yellow Nylon



Grey Nylon



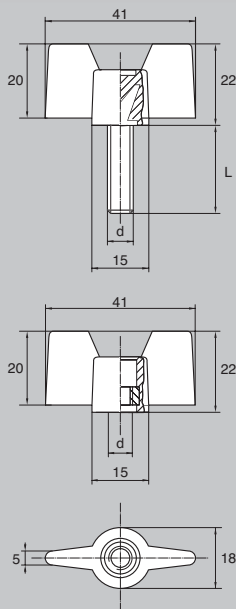

Screw

d	L	Unit of sale	Part N° (Zinc-plated steel)
M5	10	5 000	BPF60510Baz
M5	12	5 000	BPF60512Baz
M5	16	5 000	BPF60516Baz
M5	20	5 000	BPF60520Baz
M5	25	5 000	BPF60525Baz
M5	30	5 000	BPF60530Baz
M5	35	5 000	BPF60535Baz
M5	40	5 000	BPF60540Baz
M6	10	5 000	BPF60610Baz
M6	12	5 000	BPF60612Baz
M6	16	5 000	BPF60616Baz
M6	20	5 000	BPF60620Baz
M6	25	5 000	BPF60625Baz
M6	30	5 000	BPF60630Baz
M6	35	5 000	BPF60635Baz
M6	40	5 000	BPF60640Baz
M6	45	5 000	BPF60645Baz
M6	50	5 000	BPF60650Baz
M8	16	5 000	BPF60816Baz
M8	20	5 000	BPF60820Baz
M8	25	5 000	BPF60825Baz
M8	30	5 000	BPF60830Baz
M8	35	5 000	BPF60835Baz
M8	40	5 000	BPF60840Baz
M8	45	5 000	BPF60845Baz
M8	50	5 000	BPF60850Baz

> Other lengths on request.

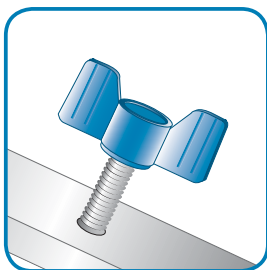

Nut

d	Unit of sale	Type	Part N° (Zinc-plated steel)
M5	2 500	Open	BPF605Baz
M6	2 500	Open	BPF606Baz
M8	2 500	Open	BPF608Baz

MATERIALS - COLOURS

Screw

STANDARD :

- Head : black Nylon - Insert : zinc-plated steel.

ON REQUEST :

- Head colours : see RAL colour chart page 510 / 511.
- Insert : stainless steel or brass.

Nut

STANDARD :

- Head : black Nylon - Insert : zinc-plated steel.

ON REQUEST :

- Head colours : see RAL colour chart page 510 / 511.
- Insert : stainless steel or brass.



Black Nylon



White Nylon



Red Nylon



Blue Nylon



Yellow Nylon



Grey Nylon



PLASTOMET > Four-stars screws / nuts BPF 70

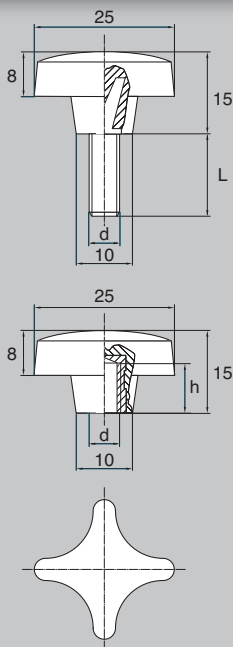

Screw

d	L	Unit of sale	Part N° (Zinc-plated steel)
M4	8	5 000	BPF7048Baz
M4	10	5 000	BPF70410Baz
M4	12	5 000	BPF70412Baz
M4	16	5 000	BPF70416Baz
M4	18	5 000	BPF70418Baz
M4	20	5 000	BPF70420Baz
M4	25	5 000	BPF70425Baz
M4	30	5 000	BPF70430Baz
M5	10	5 000	BPF70510Baz
M5	12	5 000	BPF70512Baz
M5	16	5 000	BPF70516Baz
M5	18	5 000	BPF70518Baz
M5	20	5 000	BPF70520Baz
M5	25	5 000	BPF70525Baz
M5	30	5 000	BPF70530Baz
M5	35	5 000	BPF70535Baz
M5	40	5 000	BPF70540Baz
M6	10	5 000	BPF70610Baz
M6	12	5 000	BPF70612Baz
M6	16	5 000	BPF70616Baz
M6	18	5 000	BPF70618Baz
M6	20	5 000	BPF70620Baz
M6	25	5 000	BPF70625Baz
M6	30	5 000	BPF70630Baz
M6	35	5 000	BPF70635Baz
M6	40	5 000	BPF70640Baz
M6	45	5 000	BPF70645Baz
M6	50	5 000	BPF70650Baz

Nut

d	h	Unit of sale	Type	Part N° (Brass)
M4	6	1 000	Closed	BPF704Bms
M5	7,5	1 000	Closed	BPF705Bms
M6	8	5 000	Closed	BPF706Bms



MATERIALS - COLOURS

Screw

STANDARD :

- Head : black Nylon - Insert : zinc-plated steel.

ON REQUEST :

- Head colours : see RAL colour chart page 510 / 511.
- Insert : stainless steel or brass.

Nut

STANDARD :

- Head : black Nylon - Insert : brass.

ON REQUEST :

- Head colours : see RAL colour chart page 510 / 511.
- Insert : stainless steel.



297



Black Nylon



White Nylon



Red Nylon



Blue Nylon



Yellow Nylon



Grey Nylon



PLASTOMET > Knurled thumb screws BPF 80 / BPF 83

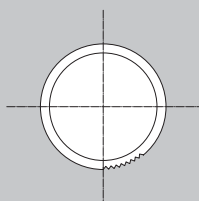
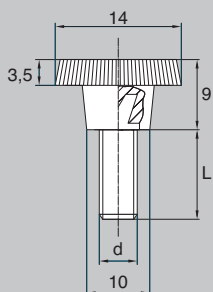
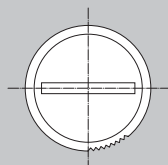
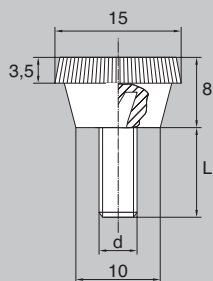

d	L	Unit of sale	Part N° (Zinc-plated steel)
M3		ON REQUEST	
M4	8	2 500	BPF8048Baz
M4	10	2 500	BPF80410Baz
M4	12	2 500	BPF80412Baz
M4	16	2 500	BPF80416Baz
M4	18	2 500	BPF80418Baz
M4	20	2 500	BPF80420Baz
M4	25	2 500	BPF80425Baz
M4	30	2 500	BPF80430Baz

d	L	Unit of sale	Part N° (Zinc-plated steel)
M3	8	2 500	BPF8338Baz
M3	10	2 500	BPF83310Baz
M3	12	2 500	BPF83312Baz
M3	16	2 500	BPF83316Baz
M3	18	2 500	BPF83318Baz
M3	20	2 500	BPF83320Baz
M4	8	2 500	BPF8348Baz
M4	10	2 500	BPF83410Baz
M4	12	2 500	BPF83412Baz
M4	16	2 500	BPF83416Baz
M4	18	2 500	BPF83418Baz
M4	20	2 500	BPF83420Baz
M4	25	2 500	BPF83425Baz
M4	30	2 500	BPF83430Baz
M5	10	2 500	BPF83510Baz
M5	12	2 500	BPF83512Baz
M5	16	2 500	BPF83516Baz
M5	18	2 500	BPF83518Baz
M5	20	2 500	BPF83520Baz
M5	25	2 500	BPF83525Baz
M5	30	2 500	BPF83530Baz
M5	35	2 500	BPF83535Baz
M5	40	2 500	BPF83540Baz
M6		ON REQUEST	

MATERIALS - COLOURS

STANDARD :

- Head : black Nylon.
- Insert : zinc-plated steel.

ON REQUEST :

- Head colours : see RAL colour chart page 510 / 511.
- Insert : stainless steel or brass.

Knurled slotted thumb screw >>
BPF 80



<< Knurled thumb screw
BPF 83



299



Black Nylon



White Nylon



Red Nylon



Blue Nylon



Yellow Nylon



Grey Nylon



PLASTOMET > Knurled thumb screws BPF 82 / BPF 86

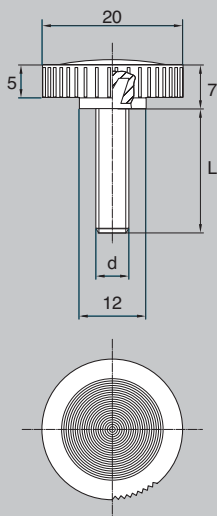
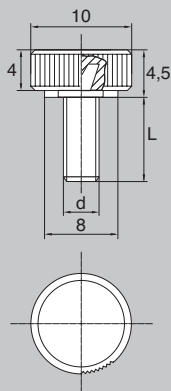

d	L	Unit of sale	Part N° (Zinc-plated steel)
M3	8	2 500	BPF8238Baz
M3	10	2 500	BPF82310Baz
M3	12	2 500	BPF82312Baz
M3	16	2 500	BPF82316Baz
M3	18	2 500	BPF82318Baz
M3	20	2 500	BPF82320Baz

d	L	Unit of sale	Part N° (Zinc-plated steel)
M4	8	5 000	BPF8648Baz
M4	10	5 000	BPF86410Baz
M4	12	5 000	BPF86412Baz
M4	16	5 000	BPF86416Baz
M4	18	5 000	BPF86418Baz
M4	20	5 000	BPF86420Baz
M4	25	5 000	BPF86425Baz
M4	30	5 000	BPF86430Baz
M5	10	5 000	BPF86510Baz
M5	12	5 000	BPF86512Baz
M5	16	5 000	BPF86516Baz
M5	18	5 000	BPF86518Baz
M5	20	5 000	BPF86520Baz
M5	25	5 000	BPF86525Baz
M5	30	5 000	BPF86530Baz
M5	35	5 000	BPF86535Baz
M5	40	5 000	BPF86540Baz
M6	10	5 000	BPF86610Baz
M6	12	5 000	BPF86612Baz
M6	16	5 000	BPF86616Baz
M6	18	5 000	BPF86618Baz
M6	20	5 000	BPF86620Baz
M6	25	5 000	BPF86625Baz
M6	30	5 000	BPF86630Baz
M6	35	5 000	BPF86635Baz
M6	40	5 000	BPF86640Baz
M6	45	5 000	BPF86645Baz
M6	50	5 000	BPF86650Baz

MATERIALS - COLOURS

STANDARD :

- Head : black Nylon.
- Insert : zinc-plated steel.

ON REQUEST :

- Head colours : see RAL colour chart page 510 / 511.
- Knurled thumb screws BPF 82, M4 x 8 up to 30 mm.
- Insert : stainless steel or brass.

Knurled thumb screw >>
BPF 82 - M3 x...



<< Knurled thumb screw
BPF 86 - M4 up to M6



301

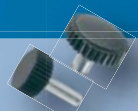

Black Nylon



White Nylon



Red Nylon



Blue Nylon



Yellow Nylon



Grey Nylon

> For this screw type in full Nylon, please contact us.



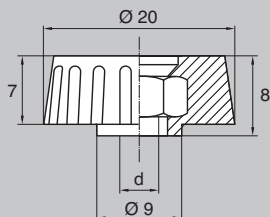

Nut BPF 84

d	Unit of sale	Type	Part N° (Zinc-plated steel)
M4	1 000	Open	BPF844Baz
M5	1 000	Open	BPF845Baz
M6	1 000	Open	BPF846Baz

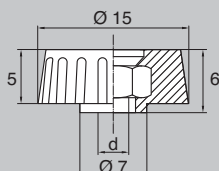

Nut BPF 85

d	Unit of sale	Type	Part N° (Zinc-plated steel)
M3	1 000	Open	BPF853Baz
M4	1 000	Open	BPF854Baz

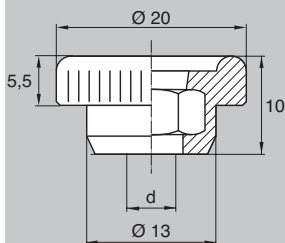

Nut BPF 105

d	Unit of sale	Type	Part N° (Zinc-plated steel)
M3	1 000	Open	BPF1053Baz
M4	1 000	Open	BPF1054Baz
M5	1 000	Open	BPF1055Baz

MATERIALS - COLOURS

STANDARD :

- Head : black Nylon.
- Insert : zinc-plated steel.

ON REQUEST :

- Head colours : see RAL colour chart page 510 / 511.
- Insert : stainless steel or brass.

Knurled nut
BPF 84



Knurled nut
BPF 85



Knurled nut
BPF 105



Black Nylon



White Nylon



Red Nylon



Blue Nylon



Yellow Nylon



Grey Nylon



PLASTOMET > Knurled screws / nuts BPF 90

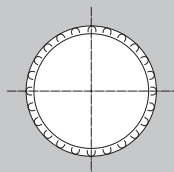
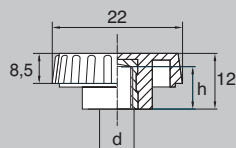
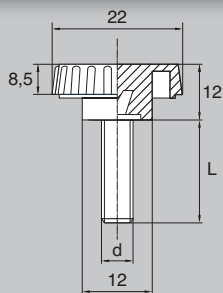

Screw

d	L	Unit of sale	Part N° (Zinc-plated steel)
M4	8	5 000	BPF9048Baz
M4	10	2 500	BPF90410Baz
M4	12	5 000	BPF90412Baz
M4	16	2 500	BPF90416Baz
M4	18	5 000	BPF90418Baz
M4	20	2 500	BPF90420Baz
M4	25	2 500	BPF90425Baz
M4	30	5 000	BPF90430Baz
M5	10	2 500	BPF90510Baz
M5	12	5 000	BPF90512Baz
M5	16	2 500	BPF90516Baz
M5	18	5 000	BPF90518Baz
M5	20	2 500	BPF90520Baz
M5	25	2 500	BPF90525Baz
M5	30	5 000	BPF90530Baz
M5	35	5 000	BPF90535Baz
M5	40	5 000	BPF90540Baz
M6	10	2 500	BPF90610Baz
M6	12	5 000	BPF90612Baz
M6	16	2 500	BPF90616Baz
M6	18	5 000	BPF90618Baz
M6	20	2 500	BPF90620Baz
M6	25	2 500	BPF90625Baz
M6	30	5 000	BPF90630Baz
M6	35	5 000	BPF90635Baz
M6	40	5 000	BPF90640Baz
M6	45	5 000	BPF90645Baz
M6	50	5 000	BPF90650Baz

Nut

d	h	Unit of sale	Type	Part N° (Brass)
M4	6	1 000	Closed	BPF904Bms
M5	7,5	1 000	Closed	BPF905Bms
M6	9	1 000	Closed	BPF906Bms



MATERIALS - COLOURS

Screw

STANDARD :

- Head : black Nylon - Insert : zinc-plated steel.

ON REQUEST :

- Head colours : see RAL colour chart page 510 / 511.
- Insert : stainless steel or brass.

Nut

STANDARD :

- Head : black Nylon - Insert : brass.

ON REQUEST :

- Head colours : see RAL colour chart page 510 / 511.
- Insert : stainless steel.



Black Nylon



White Nylon



Red Nylon



Blue Nylon



Yellow Nylon



Grey Nylon



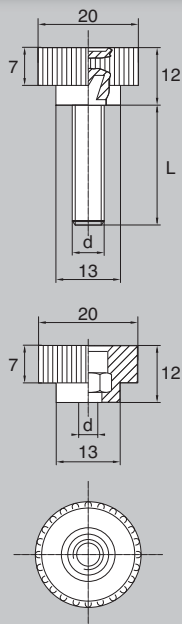

Screw

d	L	Unit of sale	Part N° (Zinc-plated steel)
M4		ON REQUEST	
M5	10	2 500	BPF100510Baz
M5	12	5 000	BPF100512Baz
M5	16	2 500	BPF100516Baz
M5	18	5 000	BPF100518Baz
M5	20	2 500	BPF100520Baz
M5	25	2 500	BPF100525Baz
M5	30	5 000	BPF100530Baz
M5	35	5 000	BPF100535Baz
M5	40	5 000	BPF100540Baz
M6	10	2 500	BPF100610Baz
M6	12	5 000	BPF100612Baz
M6	16	2 500	BPF100616Baz
M6	18	5 000	BPF100618Baz
M6	20	2 500	BPF100620Baz
M6	25	2 500	BPF100625Baz
M6	30	5 000	BPF100630Baz
M6	35	5 000	BPF100635Baz
M6	40	5 000	BPF100640Baz
M6	45	5 000	BPF100645Baz
M6	50	5 000	BPF100650Baz

306



Nut

d	Unit of sale	Type	Part N° (Zinc-plated steel)
M4	1 000	Open	BPF1004Baz
M5	1 000	Open	BPF1005Baz
M6	1 000	Open	BPF1006Baz

MATERIALS - COLOURS

Screw

STANDARD :

- Head : black Nylon - Insert : zinc-plated steel.

ON REQUEST :

- Head colours : see RAL colour chart page 510 / 511.
- Insert : stainless steel or brass.

Nut

STANDARD :

- Head : black Nylon - Insert : zinc-plated steel.

ON REQUEST :

- Head colours : see RAL colour chart page 510 / 511.
- Insert : stainless steel or brass.

Bülte

PLASTOMET

307



Black Nylon



White Nylon



Red Nylon



Blue Nylon



Yellow Nylon



Grey Nylon



PLASTOMET > Conical knurled screws BPF 110

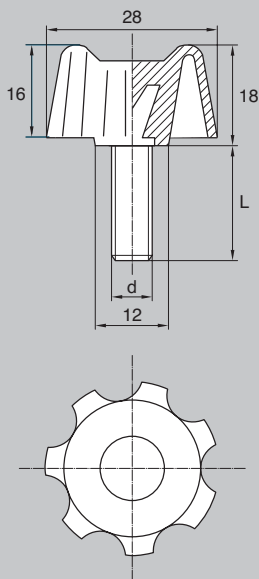

308



Screw

d	L	Unit of sale	Part N° (Zinc-plated steel)
M5	10	5 000	BPF110510Baz
M5	12	5 000	BPF110512Baz
M5	16	5 000	BPF110516Baz
M5	18	5 000	BPF110518Baz
M5	20	5 000	BPF110520Baz
M5	25	5 000	BPF110525Baz
M5	30	5 000	BPF110530Baz
M5	35	5 000	BPF110535Baz
M5	40	5 000	BPF110540Baz
M6	10	5 000	BPF110610Baz
M6	12	5 000	BPF110612Baz
M6	16	5 000	BPF110616Baz
M6	18	5 000	BPF110618Baz
M6	20	5 000	BPF110620Baz
M6	25	5 000	BPF110625Baz
M6	30	5 000	BPF110630Baz
M6	35	5 000	BPF110635Baz
M6	40	5 000	BPF110640Baz
M6	50	5 000	BPF110650Baz
M8	16	5 000	BPF110816Baz
M6	18	5 000	BPF110818Baz
M8	20	5 000	BPF110820Baz
M8	25	5 000	BPF110825Baz
M8	30	5 000	BPF110830Baz
M8	35	5 000	BPF110835Baz
M8	40	5 000	BPF110840Baz
M8	45	5 000	BPF110845Baz
M8	50	5 000	BPF110850Baz
M8	60	5 000	BPF110860Baz
M8	70	5 000	BPF110870Baz

MATERIALS - COLOURS

STANDARD :

- Head : black Nylon.
- Insert : zinc-plated steel.

ON REQUEST :

- Head colours : see RAL colour chart page 510 / 511.
- Insert : stainless steel or brass.



309



Black Nylon



White Nylon



Red Nylon



Blue Nylon



Yellow Nylon



Grey Nylon



PLASTOMET > Binder posts BPF 120

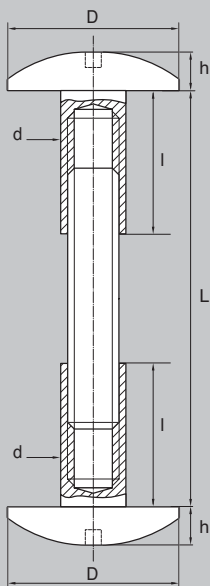

Ø	h
M4	2,5
M6	3,0
M8	3,0
M10	3,0

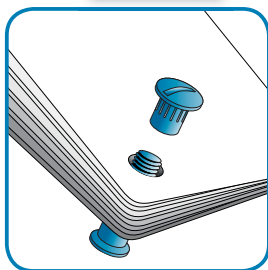

Screw

Ø	L	d	D	l	Unit of sale	Part N° (Zinc-plated steel)
M4	20	5,0	12,0	10,0	1 000	BPF120420Baz
M4	25	5,0	12,0	10,0	1 000	BPF120425Baz
M4	30	5,0	12,0	10,0	1 000	BPF120430Baz
M4	35	5,0	12,0	10,0	1 000	BPF120435Baz
M4	40	5,0	12,0	10,0	1 000	BPF120440Baz
M4	50	5,0	12,0	10,0	1 000	BPF120450Baz
M6	20	8,0	16,0	10,0	1 000	BPF120620Baz
M6	25	8,0	16,0	10,0	1 000	BPF120625Baz
M6	30	8,0	16,0	15,0	1 000	BPF120630Baz
M6	35	8,0	16,0	15,0	1 000	BPF120635Baz
M6	40	8,0	16,0	15,0	1 000	BPF120640Baz
M6	45	8,0	16,0	15,0	1 000	BPF120645Baz
M6	50	8,0	16,0	15,0	1 000	BPF120650Baz
M6	60	8,0	16,0	15,0	1 000	BPF120660Baz
M6	70	8,0	16,0	15,0	1 000	BPF120670Baz
M8	25	12,0	20,0	12,0	1 000	BPF120825Baz
M8	30	12,0	20,0	12,0	1 000	BPF120830Baz
M8	35	12,0	20,0	12,0	1 000	BPF120835Baz
M8	40	12,0	20,0	12,0	1 000	BPF120840Baz
M8	45	12,0	20,0	12,0	1 000	BPF120845Baz
M8	50	12,0	20,0	12,0	1 000	BPF120850Baz
M8	60	12,0	20,0	12,0	1 000	BPF120860Baz
M8	70	12,0	20,0	12,0	1 000	BPF120870Baz
M8	80	12,0	20,0	12,0	1 000	BPF120880Baz
M10	25	15,0	22,0	12,0	1 000	BPF1201025Baz
M10	30	15,0	22,0	12,0	1 000	BPF1201030Baz
M10	35	15,0	22,0	12,0	1 000	BPF1201035Baz
M10	40	15,0	22,0	12,0	1 000	BPF1201040Baz
M10	45	15,0	22,0	12,0	1 000	BPF1201045Baz
M10	50	15,0	22,0	12,0	1 000	BPF1201050Baz
M10	60	15,0	22,0	12,0	1 000	BPF1201060Baz
M10	70	15,0	22,0	12,0	1 000	BPF1201070Baz
M10	80	15,0	22,0	12,0	1 000	BPF1201080Baz
M10	100	15,0	22,0	12,0	1 000	BPF12010100Baz

> Other lengths on request.

MATERIALS - COLOURS

STANDARD :

- Head : black Nylon.
- Insert : zinc-plated steel.
- Delivered loose (in bulk), parts not assembled.

ON REQUEST :

- Head colours : see RAL colour chart page 510 / 511.
- Insert : stainless steel or brass.



311



Black Nylon



White Nylon



Red Nylon



Blue Nylon



Yellow Nylon



Grey Nylon

> This screw type in full Nylon : see page 206 or on request.



PLASTOMET > Knurled screws / nuts BPF 130

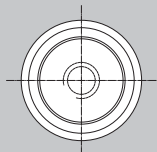
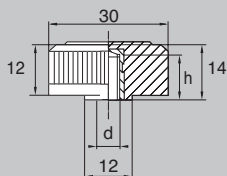
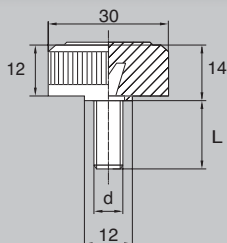

Screw

d	L	Unit of sale	Part N° (Zinc-plated steel)
M5	10	5 000	BPF130510Baz
M5	12	5 000	BPF130512Baz
M5	16	5 000	BPF130516Baz
M5	18	5 000	BPF130518Baz
M5	20	5 000	BPF130520Baz
M5	25	5 000	BPF130525Baz
M5	30	5 000	BPF130530Baz
M5	40	5 000	BPF130540Baz
M6	10	5 000	BPF130610Baz
M6	12	5 000	BPF130612Baz
M6	16	5 000	BPF130616Baz
M6	18	5 000	BPF130618Baz
M6	20	5 000	BPF130620Baz
M6	25	5 000	BPF130625Baz
M6	30	5 000	BPF130630Baz
M6	35	5 000	BPF130635Baz
M6	40	5 000	BPF130640Baz
M6	45	5 000	BPF130645Baz
M6	50	5 000	BPF130650Baz
M8	16	5 000	BPF130816Baz
M8	18	5 000	BPF130818Baz
M8	20	5 000	BPF130820Baz
M8	25	5 000	BPF130825Baz
M8	30	5 000	BPF130830Baz
M8	35	5 000	BPF130835Baz
M8	40	5 000	BPF130840Baz
M8	45	5 000	BPF130845Baz
M8	50	5 000	BPF130850Baz

Nut

d	h	Unit of sale	Type	Part N° (Brass)
M6	9	1 000	Closed	BPF1306Bms

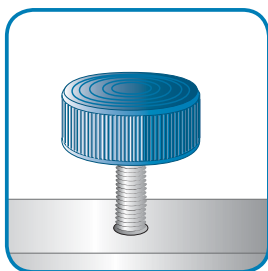

MATERIALS - COLOURS

Screw

STANDARD :

- Head : black Nylon.
- Insert : zinc-plated steel.

ON REQUEST :

- Head colours : see RAL colour chart page 510 / 511.
- Insert : stainless steel or brass.

Nut

STANDARD :

- Head : black Nylon.
- Insert : brass.

ON REQUEST :

- Head colours : see RAL colour chart page 510 / 511.
- Insert : stainless steel.



313

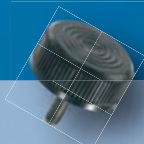

Black Nylon



White Nylon



Red Nylon



Blue Nylon



Yellow Nylon



Grey Nylon



PLASTOMET > Wing screws / nuts BPF 150

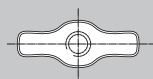
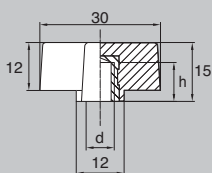
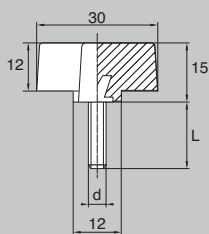

Screw

d	L	Unit of sale	Part N° (Zinc-plated steel)
M4	10	5 000	BPF150410Baz
M4	12	5 000	BPF150412Baz
M4	16	5 000	BPF150416Baz
M4	18	5 000	BPF150418Baz
M4	20	5 000	BPF150420Baz
M4	25	5 000	BPF150425Baz
M4	30	5 000	BPF150430Baz
M4	35	5 000	BPF150435Baz
M5	10	5 000	BPF150510Baz
M5	12	5 000	BPF150512Baz
M5	16	5 000	BPF150516Baz
M5	18	5 000	BPF150518Baz
M5	20	5 000	BPF150520Baz
M5	25	5 000	BPF150525Baz
M5	30	5 000	BPF150530Baz
M5	35	5 000	BPF150535Baz
M5	40	5 000	BPF150540Baz
M6	10	5 000	BPF150610Baz
M6	12	5 000	BPF150612Baz
M6	16	5 000	BPF150616Baz
M6	18	5 000	BPF150618Baz
M6	20	5 000	BPF150620Baz
M6	25	5 000	BPF150625Baz
M6	30	5 000	BPF150630Baz
M6	35	5 000	BPF150635Baz
M6	40	5 000	BPF150640Baz
M6	45	5 000	BPF150645Baz
M6	50	5 000	BPF150650Baz

Nut

d	h	Unit of sale	Type	Part N° (Brass)
M4	6,0	5 000	Closed	BPF1504Bms
M5	7,5	5 000	Closed	BPF1505Bms
M6	9,0	5 000	Closed	BPF1506Bms

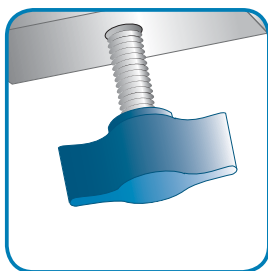

MATERIALS - COLOURS

Screw

STANDARD :

- Head : black Nylon.
- Insert : zinc-plated steel.

ON REQUEST :

- Head colours : see RAL colour chart page 510 / 511.
- Insert : stainless steel or brass.

Nut

STANDARD :

- Head : black Nylon.
- Insert : brass.

ON REQUEST :

- Head colours : see RAL colour chart page 510 / 511.
- Insert : stainless steel.



315

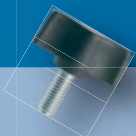

Black Nylon

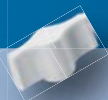

White Nylon



Red Nylon



Blue Nylon



Yellow Nylon



Grey Nylon



PLASTOMET > Washer faced hex head screws BPF 180

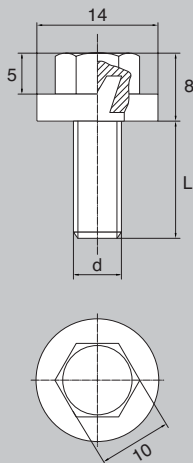

Screw

d	L	Unit of sale	Part N° (Zinc-plated steel)
M4	8	5 000	BPF18048Baz
M4	10	5 000	BPF180410Baz
M4	12	5 000	BPF180412Baz
M4	16	5 000	BPF180416Baz
M4	18	5 000	BPF180418Baz
M4	20	5 000	BPF180420Baz
M5	10	5 000	BPF180510Baz
M5	12	5 000	BPF180512Baz
M5	16	5 000	BPF180516Baz
M5	18	5 000	BPF180518Baz
M5	20	5 000	BPF180520Baz
M5	25	5 000	BPF180525Baz
M5	30	5 000	BPF180530Baz
M5	35	5 000	BPF180535Baz
M5	40	5 000	BPF180540Baz
M6	10	5 000	BPF180610Baz
M6	12	5 000	BPF180612Baz
M6	16	5 000	BPF180616Baz
M6	18	5 000	BPF180618Baz
M6	20	5 000	BPF180620Baz
M6	25	5 000	BPF180625Baz
M6	30	5 000	BPF180630Baz
M6	35	5 000	BPF180635Baz
M6	40	5 000	BPF180640Baz

316

> For all Nylon screw
M5, M6, M8, M10, M12 :
see screw Plas 180, page 175.

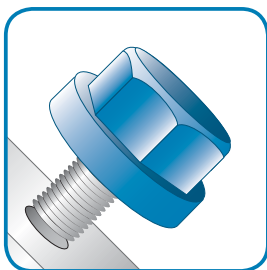

MATERIALS - COLOURS

STANDARD :

- Head : black Nylon.
- Insert : zinc-plated steel.

ON REQUEST :

- Head colours : see RAL colour chart page 510 / 511.
- Insert : stainless steel or brass.



317



Black Nylon



White Nylon



Red Nylon



Blue Nylon



Yellow Nylon



Grey Nylon



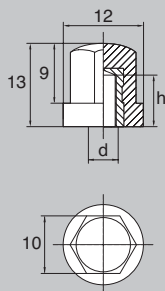

Nut BPF 181

d	h	Unit of sale	Type	Part N° (Brass)
M4	6,0	2 500	Closed	BPF1814Bms
M5	7,5	2 500	Closed	BPF1815Bms
M6	9,0	2 500	Closed	BPF1816Bms



318

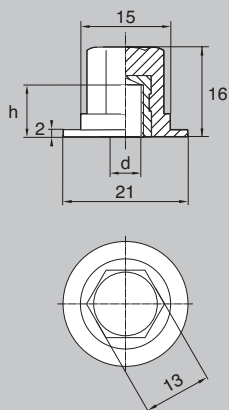

Nut BPF 183

d	h	Unit of sale	Type	Part N° (Brass)
M5	7,5	2 500	Closed	BPF1835Bms

MATERIALS - COLOURS

STANDARD :

- Head : black Nylon.
- Insert : brass.

ON REQUEST :

- Head colours : see RAL colour chart page 510 / 511.
- Insert : stainless steel.

Hex cap nut
BPF 181



Washer faced hex cap nut
BPF 183

319



Black Nylon



White Nylon



Red Nylon



Blue Nylon



Yellow Nylon



Grey Nylon



PLASTOMET > Washer faced hex head slotted screws BPF 182

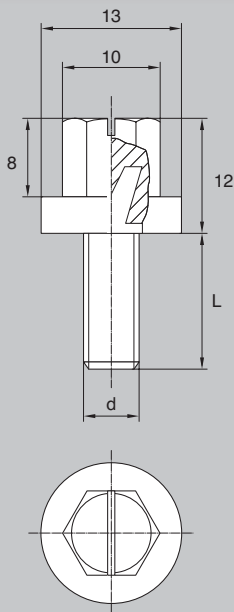

Screw

d	L	Unit of sale	Part N° (Zinc-plated steel)
M5	10	5 000	BPF182510Baz
M5	12	5 000	BPF182512Baz
M5	16	5 000	BPF182516Baz
M5	18	5 000	BPF182518Baz
M5	20	5 000	BPF182520Baz
M5	25	5 000	BPF182525Baz
M5	30	5 000	BPF182530Baz
M6	10	5 000	BPF182610Baz
M6	12	5 000	BPF182612Baz
M6	16	5 000	BPF182616Baz
M6	18	5 000	BPF182618Baz
M6	20	5 000	BPF182620Baz
M6	25	5 000	BPF182625Baz
M6	30	5 000	BPF182630Baz

320

> For this screw type in full Nylon (M5, M6, M8, M10), please contact us.

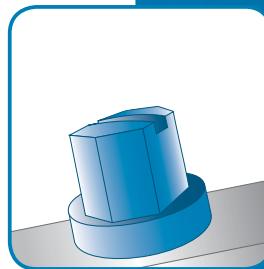
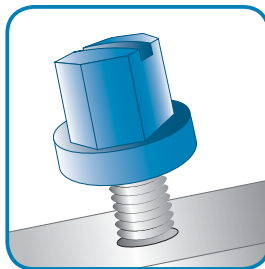

MATERIALS - COLOURS

STANDARD :

- Head : black Nylon.
- Insert : zinc-plated steel.

ON REQUEST :

- Head colours : see RAL colour chart page 510 / 511.
- Insert : stainless steel or brass.



321



Black Nylon



White Nylon



Red Nylon



Blue Nylon



Yellow Nylon



Grey Nylon



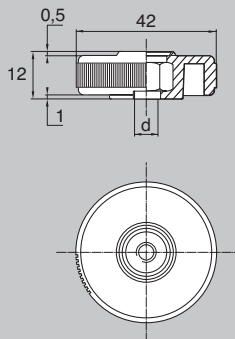

Nut BPF 196

d	Unit of sale	Type	Part N° (Zinc-plated steel)
M6	2 500	Open	BPF1966Baz
M8	2 500	Open	BPF1968Baz
M10	2 500	Open	BPF19610Baz
M12	5 000	Open	BPF19612Baz

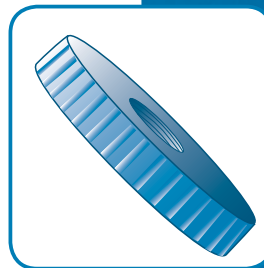

322

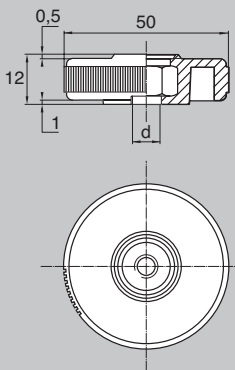

Nut BPF 197

d	Unit of sale	Type	Part N° (Zinc-plated steel)
M6	5 000	Open	BPF1976Baz
M8	5 000	Open	BPF1978Baz

MATERIALS - COLOURS

STANDARD :

- Head : black Nylon.
- Insert : zinc-plated steel.

ON REQUEST :

- Head colours : see RAL colour chart page 510 / 511.
- Insert : stainless steel or brass.

Knurled nut
BPF 196 >>

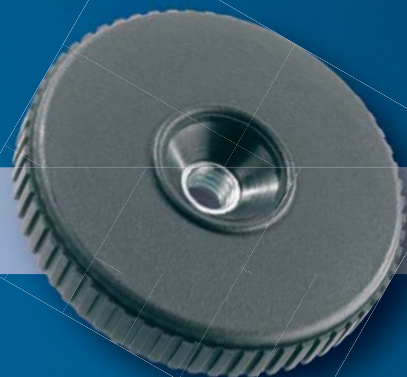

<< Knurled nut
BPF 197



Black Nylon

White Nylon

Red Nylon

Blue Nylon

Yellow Nylon

Grey Nylon



PLASTOMET > Plastomet adjustable feet

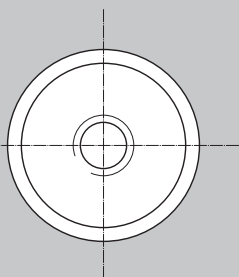
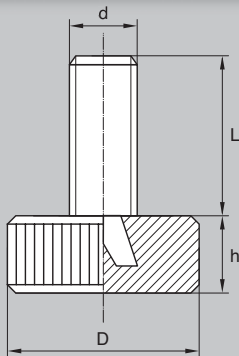

324

> Other dimensions on request.

> Tolerance on D = 30 : -1.0 mm.

> For all Nylon : see chapter "Adjustable feet" page 426 - 445.

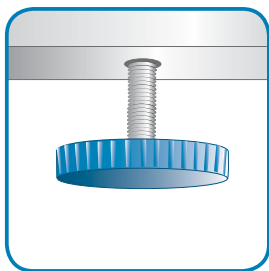

D	d	L	h	Part N°
15	M5	16	6	VER15516
15	M5	20	6	VER15520
15	M5	25	6	VER15525
15	M5	30	6	VER15530
15	M5	40	6	VER15540
15	M6	16	6	VER15616
15	M6	20	6	VER15620
15	M6	25	6	VER15625
15	M6	30	6	VER15630
15	M6	40	6	VER15640

20	M5	16	6	VER20516
20	M5	20	6	VER20520
20	M5	25	6	VER20525
20	M5	30	6	VER20530
20	M5	40	6	VER20540
20	M6	16	6	VER20616
20	M6	20	6	VER20620
20	M6	25	6	VER20625
20	M6	30	6	VER20630
20	M6	40	6	VER20640
20	M8	20	6	VER20820
20	M8	25	6	VER20825
20	M8	30	6	VER20830
20	M8	40	6	VER20840
20	M8	50	6	VER20850

25	M5	16	6	VER25516
25	M5	20	6	VER25520
25	M5	25	6	VER25525
25	M5	30	6	VER25530
25	M5	40	6	VER25540
25	M6	16	6	VER25616
25	M6	20	6	VER25620
25	M6	25	6	VER25625
25	M6	30	6	VER25630
25	M6	40	6	VER25640

D	d	L	h	Part N°
25	M8	16	6	VER25816
25	M8	20	6	VER25820
25	M8	25	6	VER25825
25	M8	30	6	VER25830
25	M8	40	6	VER25840

30	M5	20	7	VER30520
30	M5	25	7	VER30525
30	M5	30	7	VER30530
30	M5	40	7	VER30540
30	M5	50	7	VER30550
30	M6	20	7	VER30620
30	M6	25	7	VER30625
30	M6	30	7	VER30630
30	M6	40	7	VER30640
30	M6	50	7	VER30650
30	M8	20	7	VER30820
30	M8	25	7	VER30825
30	M8	30	7	VER30830
30	M8	40	7	VER30840
30	M8	50	7	VER30850

32	M8	20	9	VER32820
32	M8	25	9	VER32825
32	M8	30	9	VER32830
32	M8	40	9	VER32840
32	M8	50	9	VER32850
32	M10	25	7	VER321025
32	M10	30	7	VER321030
32	M10	40	7	VER321040
32	M10	50	7	VER321050
32	M10	60	7	VER321060

38	M10	30	9	VER381030
38	M10	40	9	VER381040
38	M10	50	9	VER381050
38	M10	60	9	VER381060

MATERIALS - COLOURS

STANDARD :

- Head : black Nylon.
- Insert : zinc-plated steel.
- Unit of sale :
 - > M5 and M6 : 1 000 pieces.
 - > M8 and M10 : 500 pieces.

ON REQUEST :

- Head colours : see RAL colour chart page 510 / 511.



Black Nylon

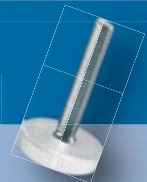

White Nylon



Red Nylon



Blue Nylon



Yellow Nylon



Grey Nylon

