

Concealed hinges A - 120° opening

Zinc plated steel version: small flat side in raw steel.

Stainless steel version: small flat side in stainless steel.

Natural POM pin diameter 6.

For pin with groove, optimal use of circlips DIN 6799 RS4 or O-ring 99-7-3723 (on request).



Part number	Material	Finish	A	C	D	Pin	Weight (g)
60-1-3760	steel	zinc plated	60	2.5	6	zinc plated pin	85
60-1-3779	steel	zinc plated	60	2.5	6	zinc plated grooved pin	85
60-1-3761	steel	zinc plated	60	2.5	6	delrin pin	85
62-1-3570	304 stainless steel	raw	60	2.5	6	304 stainless steel pin	85
62-1-3584	304 stainless steel	raw	60	2.5	6	303 stainless steel grooved pin	85
62-1-3571	304 stainless steel	raw	60	2.5	6	delrin pin	85

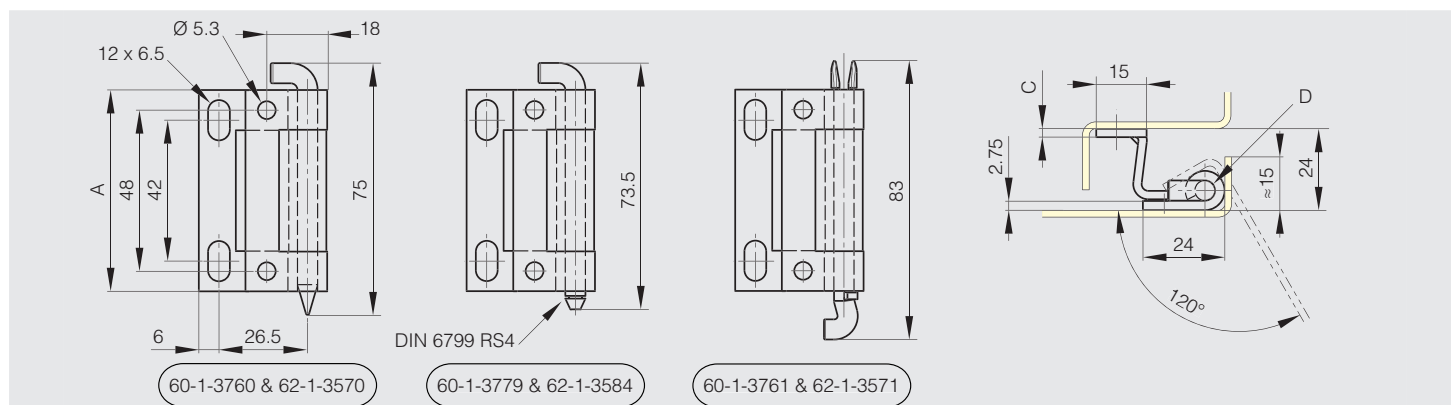

Concealed hinges B - 120° opening

Zinc plated steel version: small flat side in raw steel.

Stainless steel version: small flat side in stainless steel.

Natural POM pin diameter 6.

For pin with groove, optimal use of circlips DIN 6799 RS4 or O-ring 99-7-3723 (on request).



Part number	Material	Finish	A	C	D	Pin	Weight (g)
60-1-3762	steel	zinc plated	60	2.5	6	zinc plated pin	75
60-1-3778	steel	zinc plated	60	2.5	6	zinc plated grooved pin	75
60-1-3763	steel	zinc plated	60	2.5	6	delrin pin	75
62-1-3572	304 stainless steel	raw	60	2.5	6	304 stainless steel pin	75
62-1-3585	304 stainless steel	raw	60	2.5	6	303 stainless steel grooved pin	75
62-1-3573	304 stainless steel	raw	60	2.5	6	delrin pin	75

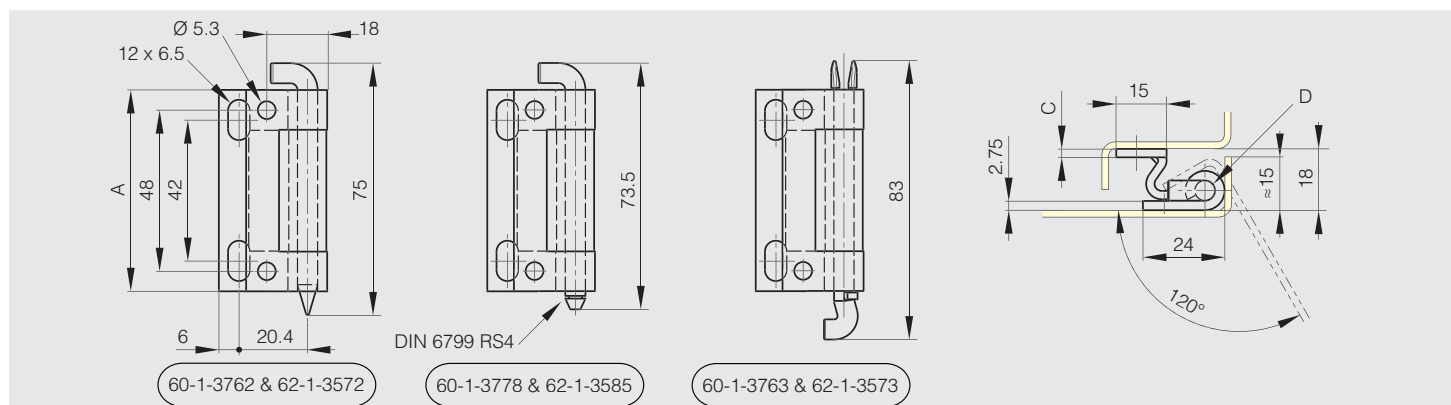

Concealed hinges

Concealed hinges for surface mounted doors only

Concealed hinge with removable pin - 110° opening



Male leaf in raw steel.
 Female leaf in zinc plated steel with stud.
 Removable pin in POM.

Part number	Material	Finish	A	B	C	Pin	Note	Weight (g)
NEW 60-1-3918	steel	raw / zinc plated	50	18	2	POM pin	male leaf in raw steel	40

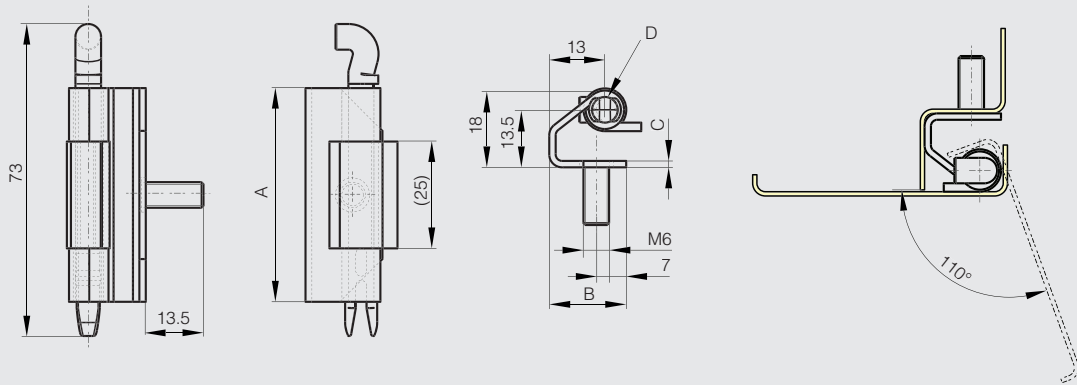

Concealed hinges with retractable pin



Quick-release concealed hinge for tool-free door removal with fixed retractable pin.

Part number	Material	Finish	A	B	E	W	Weight (g)
62-1-9000	stainless steel	raw	126	17.5	3	122°	73
62-1-9001	stainless steel	raw	126	20.5	4	117°	84
62-1-9002	stainless steel	raw	126	23.9	4.5	112°	100

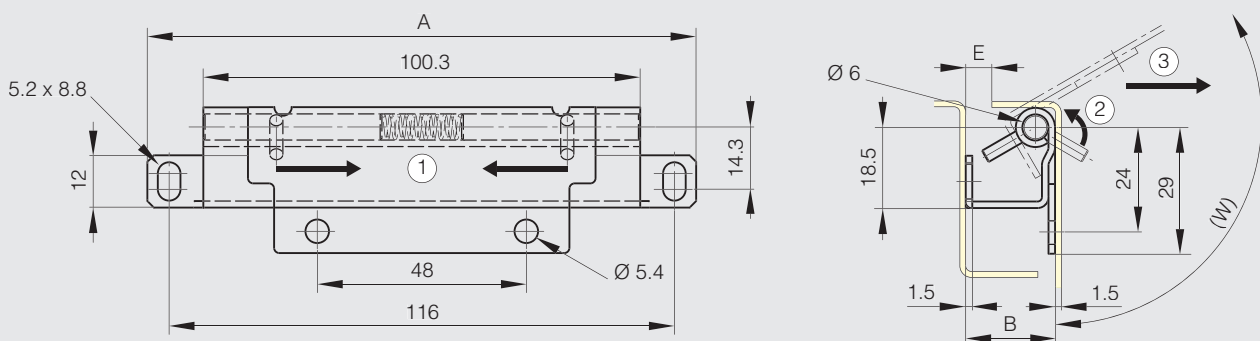

Concealed pin hinges - 100° opening

Non handed fitting.
Removable pin in 304 stainless steel.



Part number	Material	Finish	A	C	D	E	Weight (g)
12-1-3537	steel	raw	80	2	4	40	45
12-1-3538	304 stainless steel	raw	80	2	4	40	45

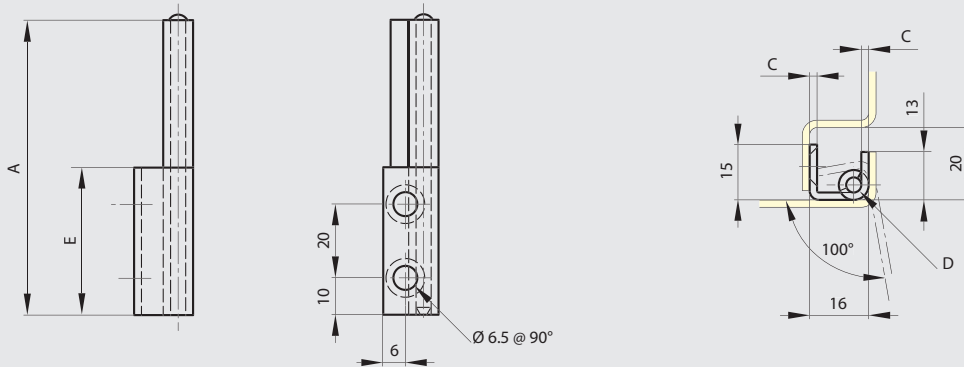

Concealed pin hinges - 120° opening

Non handed fitting.
Removable pin in 304 stainless steel.



Part number	Material	Finish	A	C	D	E	Weight (g)
12-1-3524	steel	raw	80	3	6	40	107
12-1-3528	304 stainless steel	raw	80	3	6	40	107

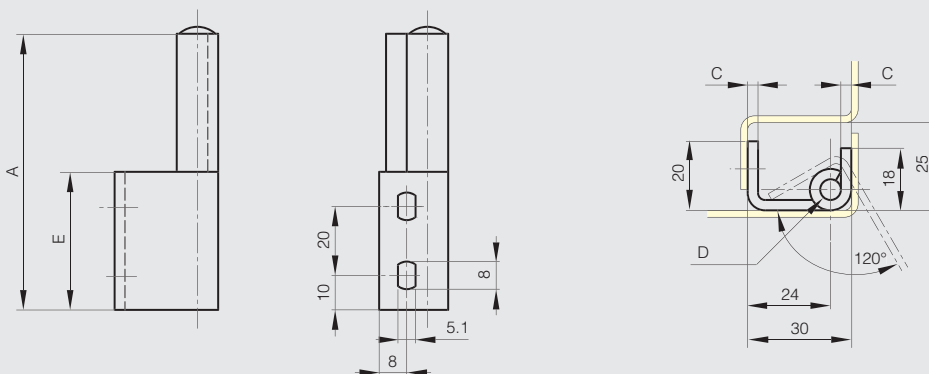

Concealed hinges with spring - 95° opening



Concealed hinges with 2 positions:

- Closing position: door remains open with an angle of 10°.
- Opening position: door opens up to 95°.

Closing of door due to spring action and door remains slightly opened.

Applications for parcel box:

- Door automatically opens after code entry.
- Door doesn't remain in opening position.



	Part number	Material	Finish	A	B	C	D	Weight (g)
NEW	71-1-3812	steel	zinc plated	51	75	3	6	200
NEW	71-1-3867	304 stainless steel	raw	51	75	3	6	200

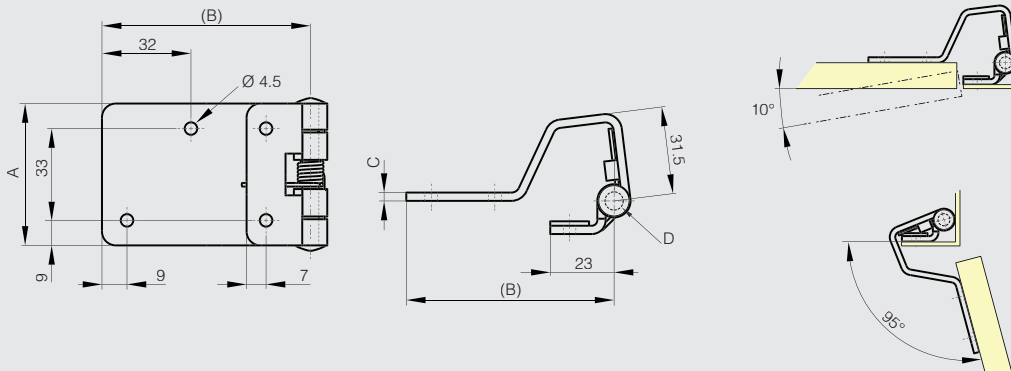

Concealed hinges without spring - 95° opening



	Part number	Material	Finish	A	B	C	D	Weight (g)
NEW	60-1-4007	steel	zinc plated	51	75	3	6	210
NEW	62-1-4008	304 stainless steel	raw	51	75	3	6	210

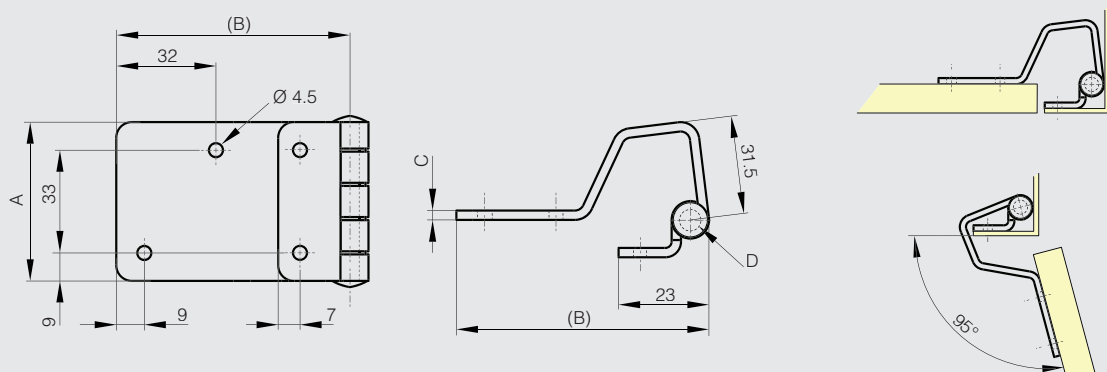

Concealed hinges

Concealed hinges for nested doors only

Concealed hinge with friction - 90° opening

Initial torque (0.7 N.m) may vary from -20% to +40%.

For indoor use only.

Can be used both for horizontal and vertical applications.



Part number	Material	Finish	A	B	C	Torque	Weight (g)
70-7-3623	304 stainless steel	polished	40	67	29.5	0.7 N.m	50

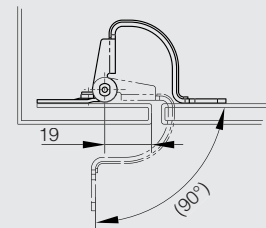
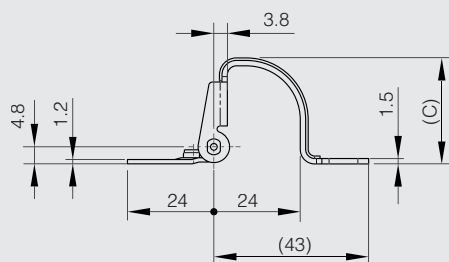
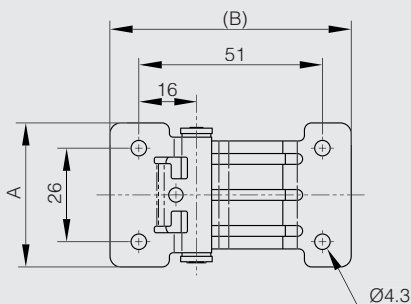

Concealed hinge - 180° opening



Part number	Material	Finish	A	B	C	D	E	F	S	Weight (g)
70-7-3544	304 stainless steel	satín	50	19	38	14	18.2	11	2.7	33

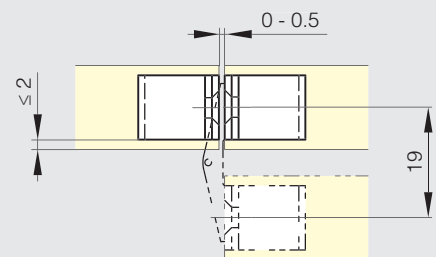
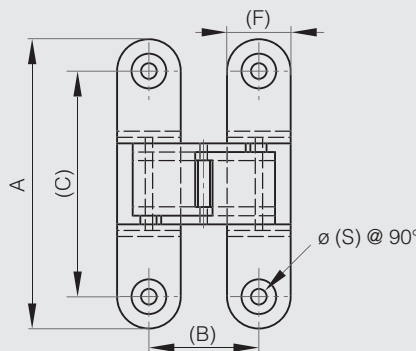
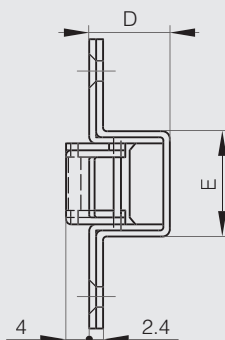

Multi link concealed hinges - 180° opening

Links and pins in 303 and 304 stainless steel.

A full product data sheet is available on our website.



Part number	Material	Finish	A	B	C	D	E	F	G	H	S	X	Y	Weight (g)
70-7-3539	zinc die-cast	chrome plated satin	43	18	32	13	11	22	5	5	3.5	≤ 2.3	0.8	36.6
70-7-3540	zinc die-cast	chrome plated satin	45	22.7	32	18.5	13	19	5	6	3.5	≤ 3	0.8	55
70-7-3541	zinc die-cast	chrome plated satin	60	22.2	47	18.5	13	33	6.5	6.5	4.3	≤ 3	1	100
70-7-3542	zinc die-cast	chrome plated satin	70	26.6	53	23	16.1	35	7	9	4.6	≤ 3.5	1.2	160
70-7-3543	zinc die-cast	chrome plated satin	100	33.2	80	27.5	20	52	9.5	9.5	5.3	≤ 4.8	1.8	350

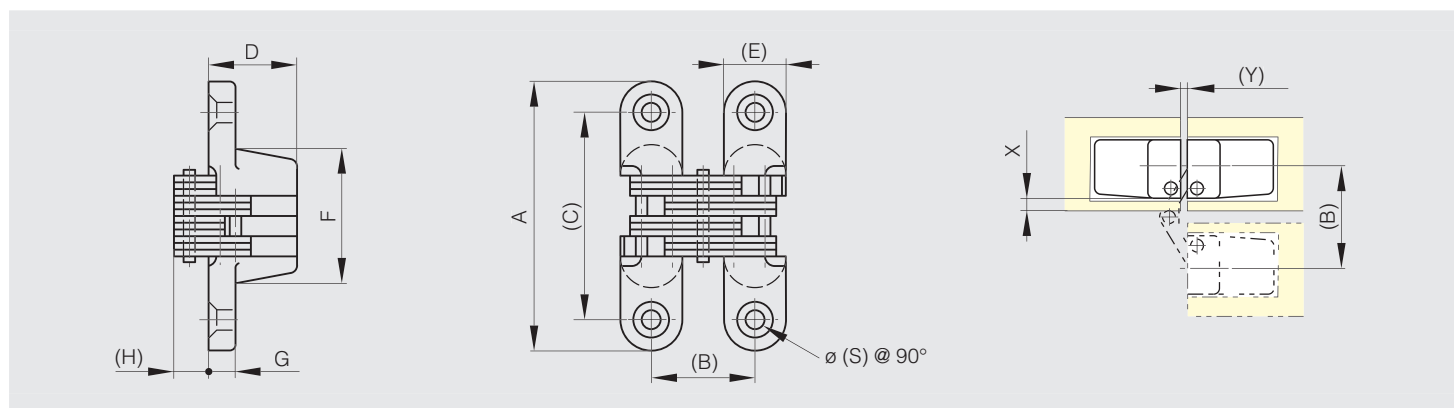

Concealed hinge - 3-D adjustable - 180° opening

3-D adjustable (height, width, depth) without removing the door.

Height adjustment: -3.0 / +3.0 mm.

Width adjustment: -3.0 / +4.0 mm.

Depth adjustment (pressure): -1.5 / +1.5 mm.

Universal: for left- and right-sided doors.

Can be installed in the frame and adjusted by just one person.

No visible screws.

Washers in POM.

Door thickness: min. 40 mm.

Door weight (for 2 hinges): up to 120 kg (Door size: max. 830 x 2015 mm).

Door weight (for 3 hinges): up to 150 kg (Door size: max. 830 x 2015 mm).



Part number	Material	Finish	■	■	■	■
70-7-3624	zinc die-cast	chrome plated mat	170	32	>40	1255

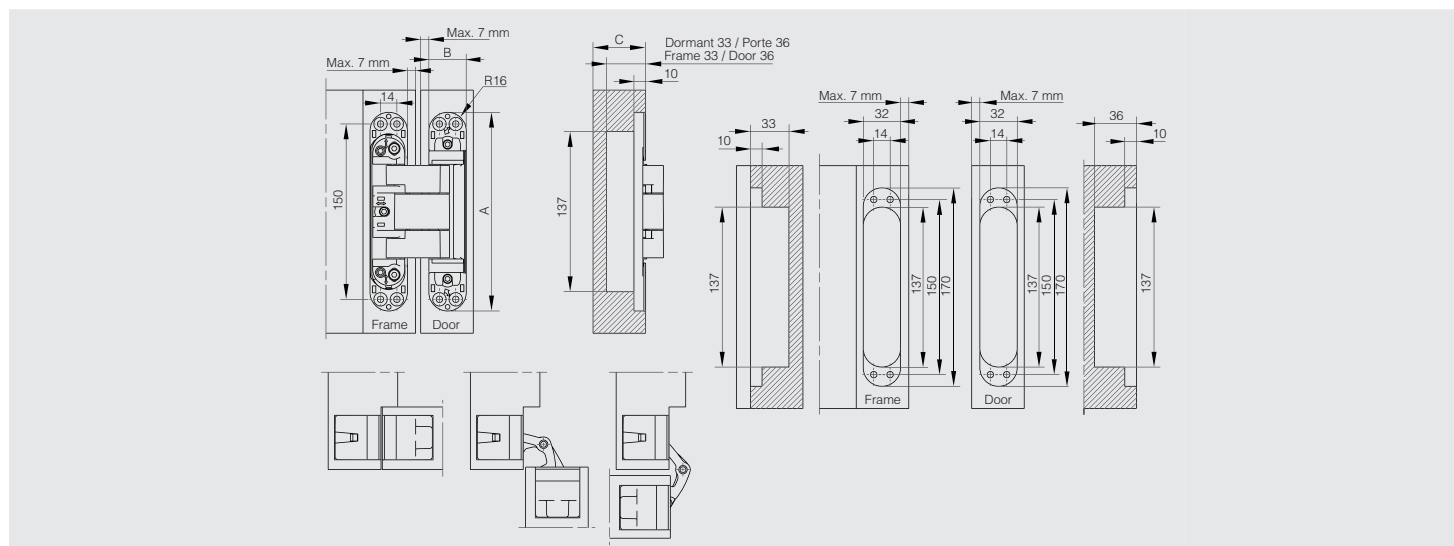

Concealed hinges

Concealed hinges for nested doors only

Concealed hinge with friction - 180° opening



180° opening angle.

Free stop for safety. Maximum friction torque of 5 N.m for one hinge (when lid is closed).

Torque decreases as the opening angle increases, making easier to open the lid.

	Part number	Material	Finish	A	B	C	S	Weight (g)
NEW	70-7-3635	zinc die-cast	satin chrome	70	31.6	53	4.6	160

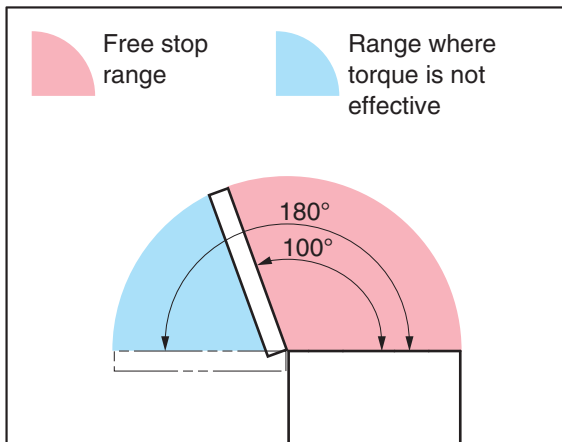
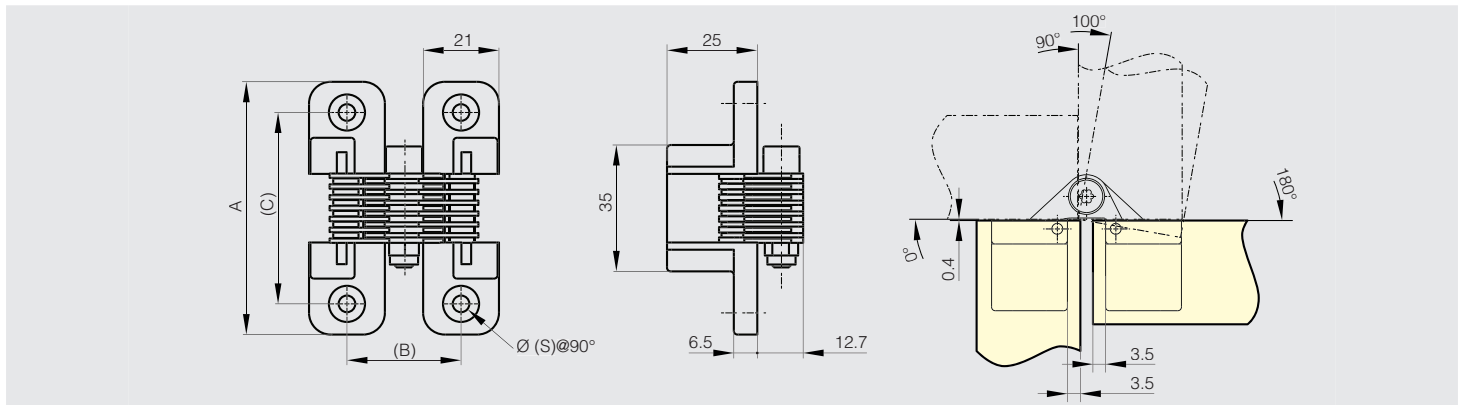

Install stopper to hold the door within the range where torque is not effective.

Torque curve

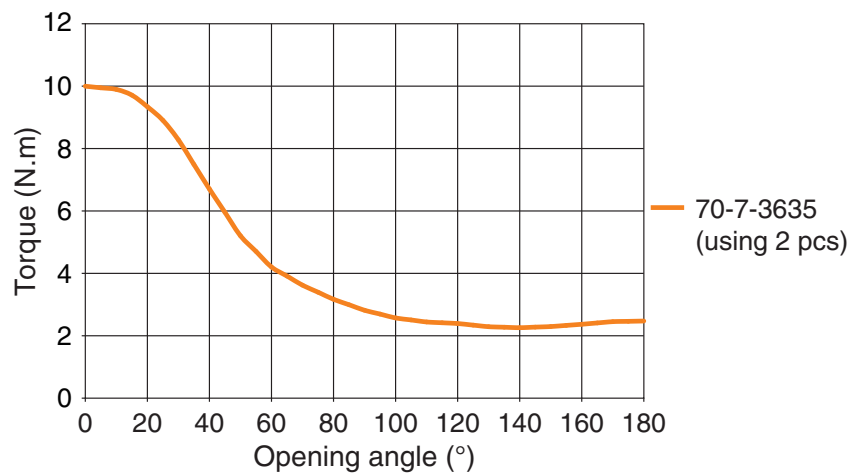

Concealed hinge with removable pin - 180° opening

Patented concealed hinge for metallic enclosures with a 180° opening.

Removable pin makes disassembly of doors easy.

Product data sheet with mounting instructions available on request or on our website.

Door thickness max: 1 mm.



Part number	Material	Finish	A	Weight (g)
73-1-3504	steel	raw	100	123

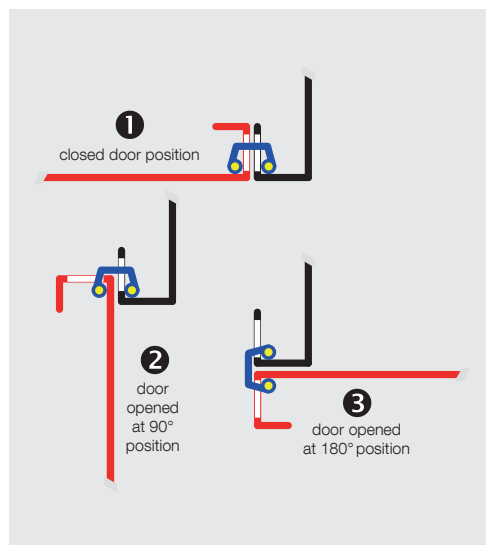
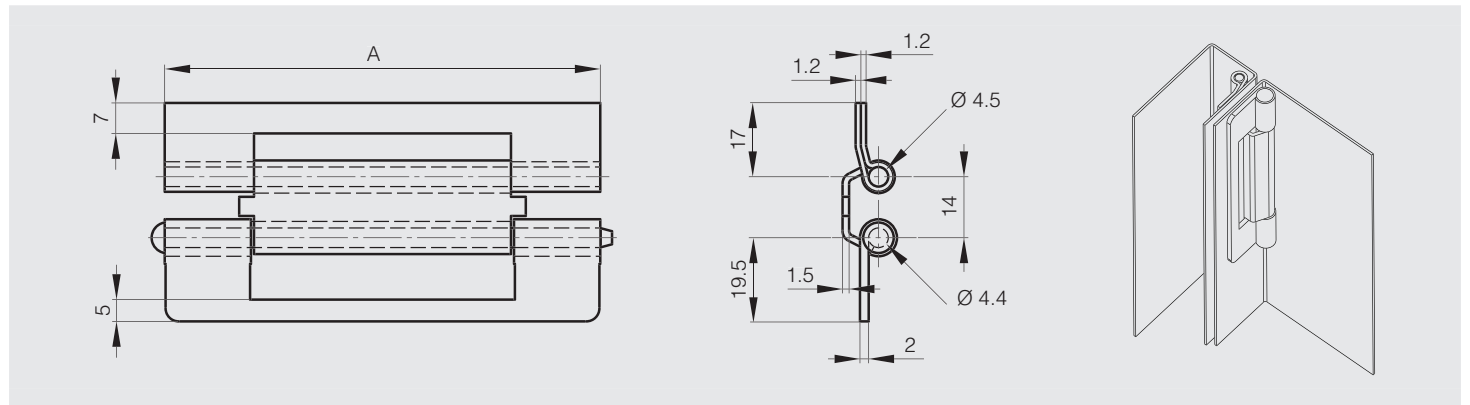

Operating of the 180° concealed hinge

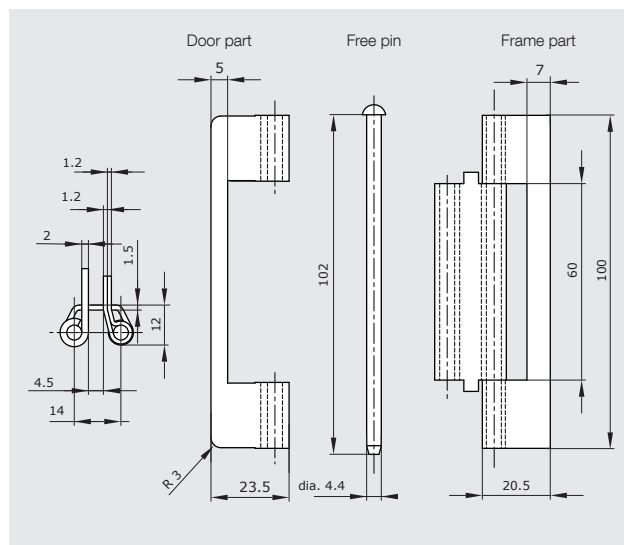

Dimensions of the 180° concealed hinge

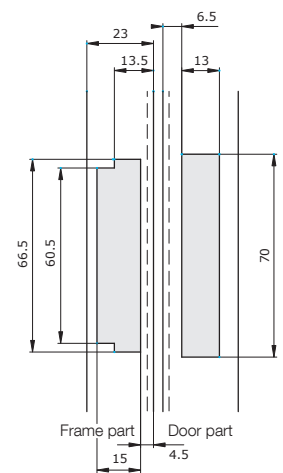

Cut-out to be made for hinge fitting

Concealed heavy duty hinges for flush doors - 90° opening

Concealed hinge for LH or RH application. The 2 main hinge parts have a central guide to prevent door from sagging during adjustment.



Part number	Material	Finish	A	B	C	D	Weight (g)
85-7-1321	steel	raw / zinc plated	60	48	3	6	189
85-7-2331	304 stainless steel	raw	60	48	3	6	189

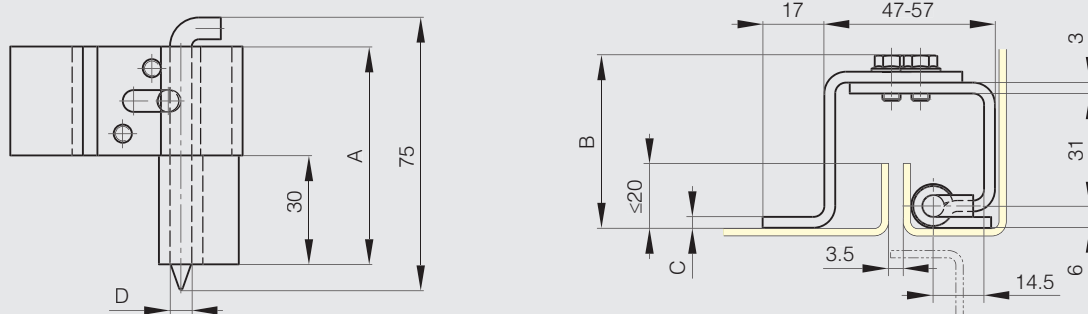

Concealed heavy duty hinges for flush doors - 90° opening

Concealed hinge for LH or RH application. The 2 main hinge parts have a central guide to prevent door from sagging during adjustment.



Part number	Material	Finish	A	B	C	D	Weight (g)
85-7-1333	steel	raw / zinc plated	80	62	4	8	420
85-7-2334	304 stainless steel	raw	80	62	4	8	420

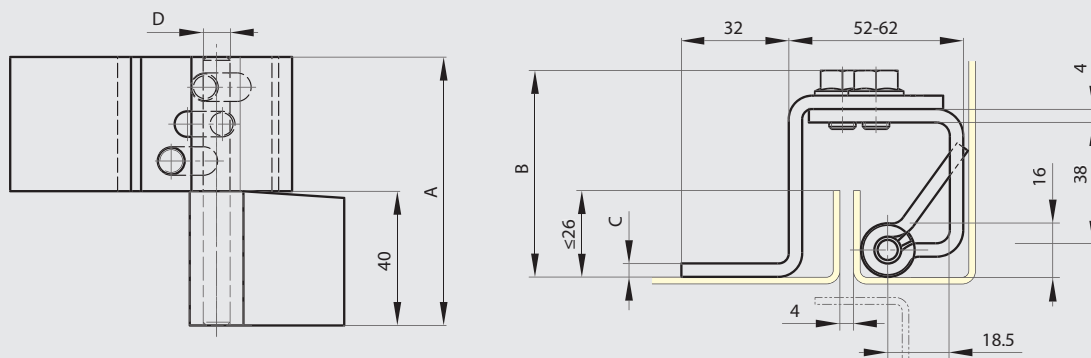

Concealed heavy duty hinges for flush doors - 90° opening

Concealed hinge for LH or RH application. The 2 main hinge parts have a central guide to prevent door from sagging during adjustment.



Part number	Material	Finish	A	B	C	D	Weight (g)
85-7-1331	steel	raw / zinc plated	80	61	4	8	412
85-7-2332	304 stainless steel	raw	80	61	4	8	412

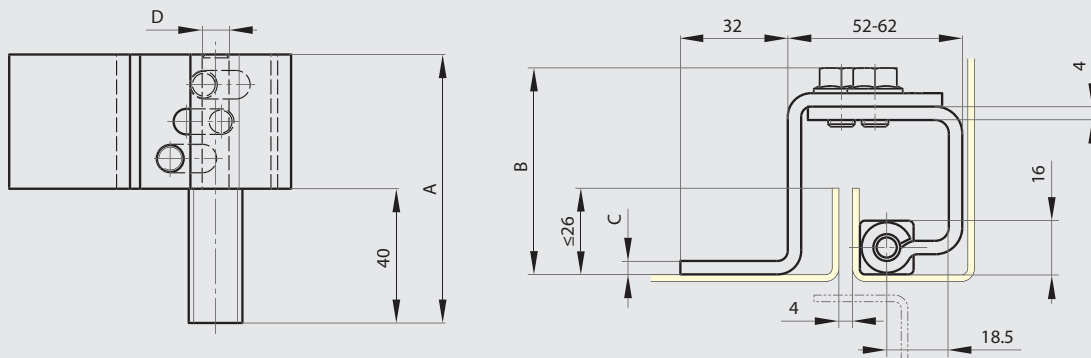

Concealed weld-on springloaded pin hinge



Part number	Material	Finish	A	B	K	Weight (g)
85-7-1030	steel	raw	53	15	15	70

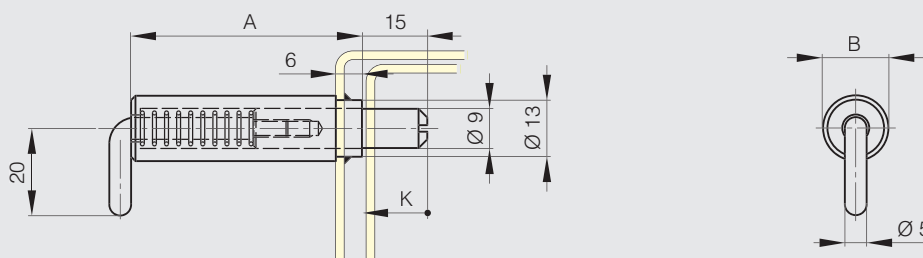

Concealed springloaded pin hinges A

Stainless steel spring. Hinges in raw steel and zinc plated steel with a zinc plated pin. Circlip in 1.4122 stainless steel.



Part number	Material	Finish	A	B	C	D	K	Note	Weight (g)
12-1-3856	steel	raw	82	18.2	2.8	6	12	type 2	46.4
12-1-3857	steel	raw	82	18.2	2.8	6	12	type 1	46.4
12-1-3854	steel	zinc plated	82	18.2	2.8	6	12	type 2	46.4
12-1-3855	steel	zinc plated	82	18.2	2.8	6	12	type 1	46.4
12-1-3858	304 stainless steel	raw	82	18.2	2.8	6	12	type 2	46.4
12-1-3859	304 stainless steel	raw	82	18.2	2.8	6	12	type 1	46.4

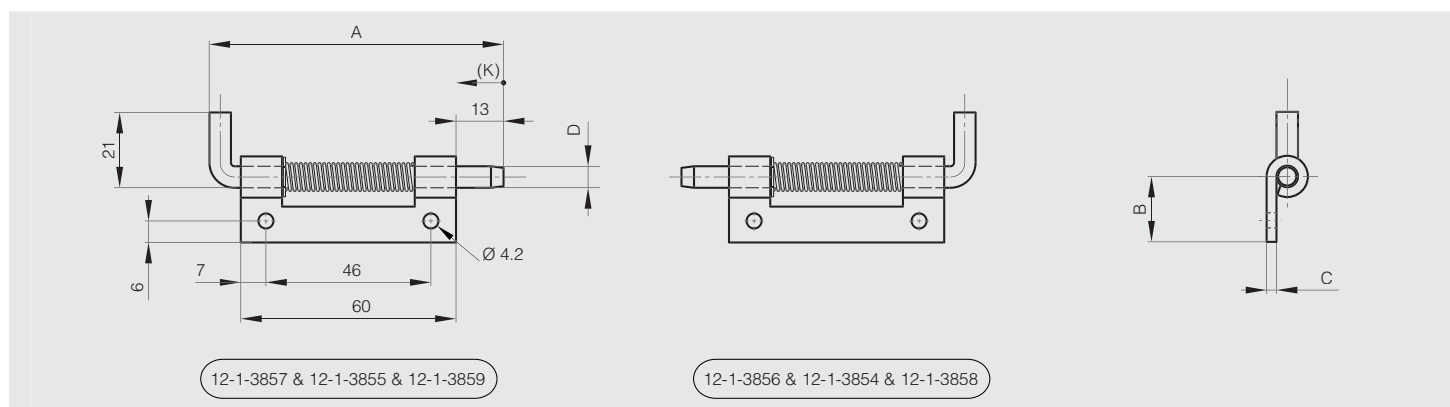

Concealed springloaded pin hinges B

Stainless steel spring. Hinges in raw steel and zinc plated steel with a zinc plated pin. Circlip in 1.4122 stainless steel.



Part number	Material	Finish	A	B	C	D	K	Note	Weight (g)
12-1-3950	steel	raw	82	21	14	5	12	type 2	38.5
12-1-3951	steel	raw	82	21	14	5	12	type 1	38.5
12-1-3860	steel	zinc plated	82	21	14	5	12	type 2	38.5
12-1-3861	steel	zinc plated	82	21	14	5	12	type 1	38.5
12-1-3862	304 stainless steel	raw	82	21	14	5	12	type 2	38.5
12-1-3863	304 stainless steel	raw	82	21	14	5	12	type 1	38.5

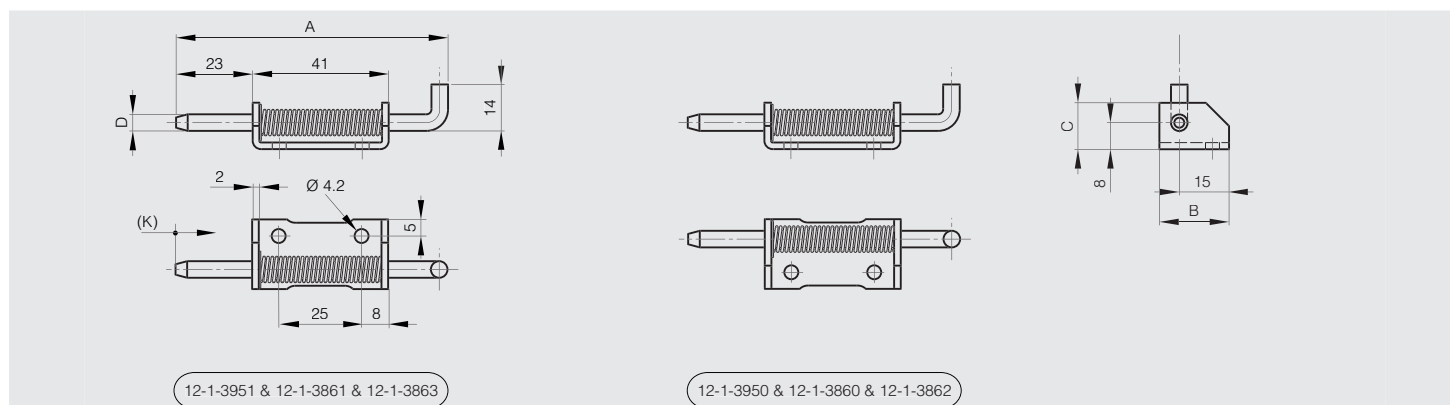

Concealed hinge A - 90° opening

Main features:

- For nested doors or surface mounted doors.
- High resistance to bending and twisting.
- For horizontal or vertical applications.
- 90° opening max.



Same installation as «Concealed hinge C - 90° opening».

Door thickness max. 20 mm.

Minimal gap of 0.5 to 1.5 mm between door and frame.

A full product data sheet is available on our website.



Part number	Material	Finish	A	B	Weight (g)
70-1-3628	steel	zinc plated	30.2	126.5	78

Concealed hinge B - 90° opening

Main features:

- For nested doors or surface mounted doors.
- High resistance to bending and twisting.
- For horizontal or vertical applications.
- 90° opening max.



Same installation as «Concealed hinge C - 90° opening».

Door thickness max. 20 mm.

Minimal gap of 0.5 to 1.5 mm between door and frame.

A full product data sheet is available on our website.



Part number	Material	Finish	A	B	Weight (g)
70-1-3627	steel	zinc plated	30.2	126.5	78

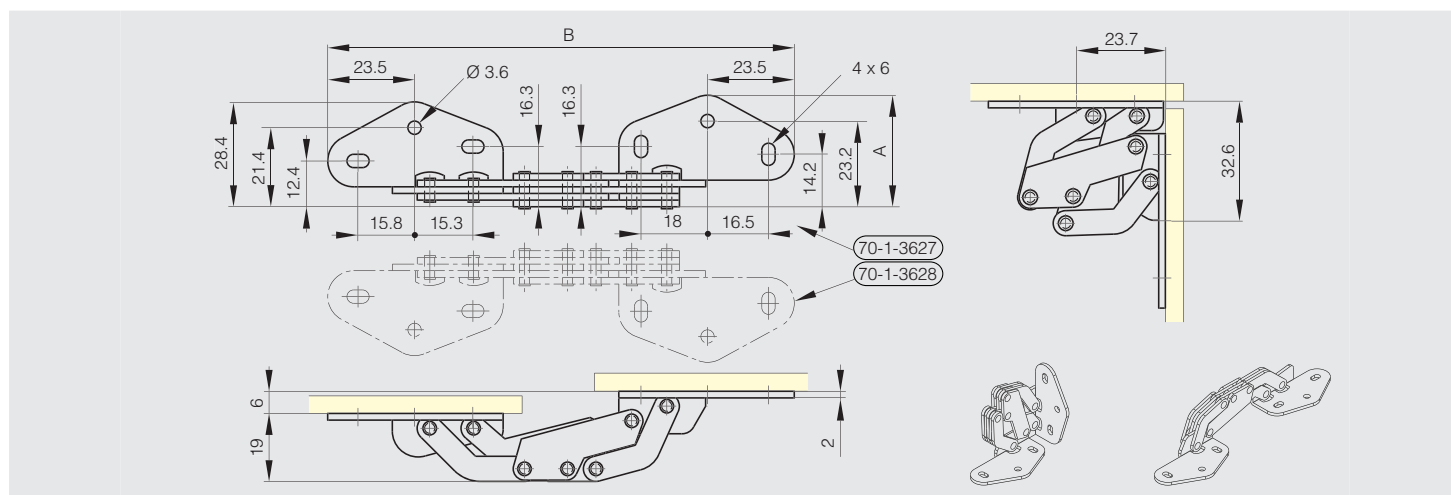

Concealed hinge C - 90° opening

Main features:

- For nested doors or surface mounted doors.
- High resistance to bending and twisting.
- For horizontal or vertical applications.
- 90° opening max.



Door thickness max. 20 mm.

Minimal gap of 0.5 to 1.5 mm between door and frame.

A full product data sheet is available on our website.



Part number	Material	Finish	A	B	Weight (g)
70-1-3626	steel	zinc plated	58.6	126.5	150

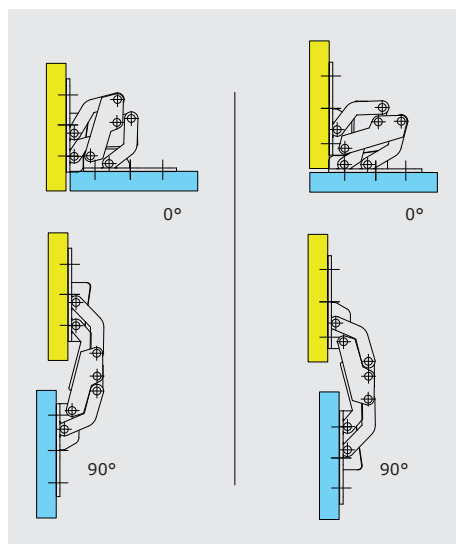
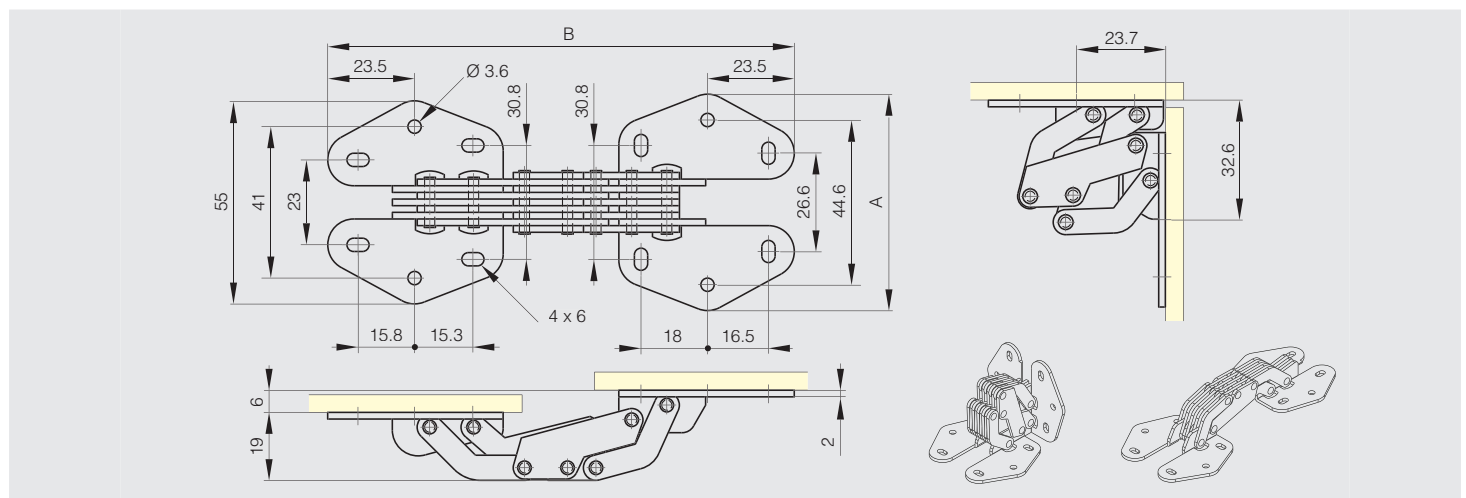

Nested door assembly shown

Surface mounted assembly shown

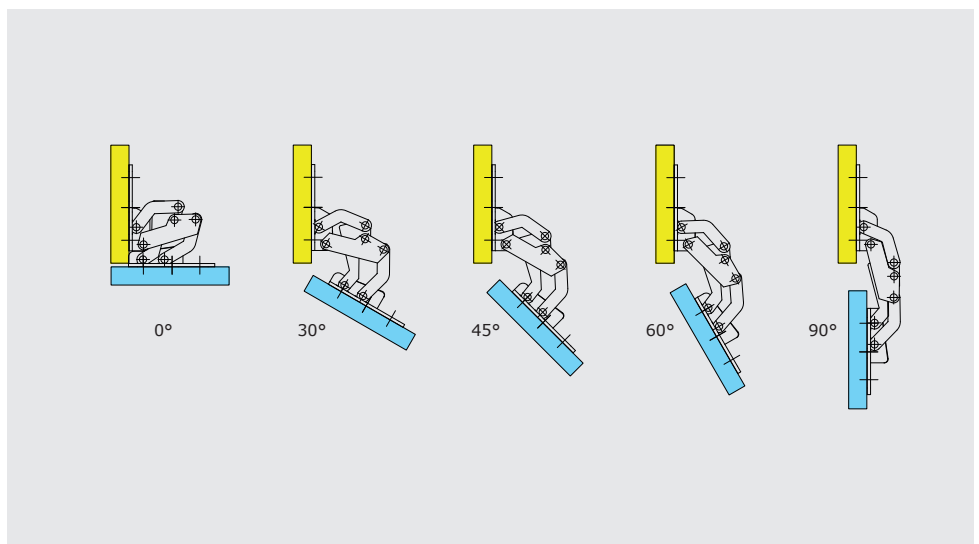

Surface mounted assembly shown

Concealed hinges

Concealed hinges for surface mounted doors or nested doors

Concealed hinges - 90° opening



Pins and links in 430 stainless steel for 70-1-3520.
 Pins and links in 316L stainless steel for 70-1-3625.
 Mounting features:

- For nested doors or surface mounted doors.
- LH or RH options.
- For horizontal or vertical applications.

A full product data sheet is available on our website.

Refer to the product data sheet on our website for mounting instructions.



	Part number	Material	Finish	A	B	C	Weight (g)
	70-1-3520	steel	zinc plated	44	29	32	64
NEW	70-1-3625	316L stainless steel	raw	44	29	32	64

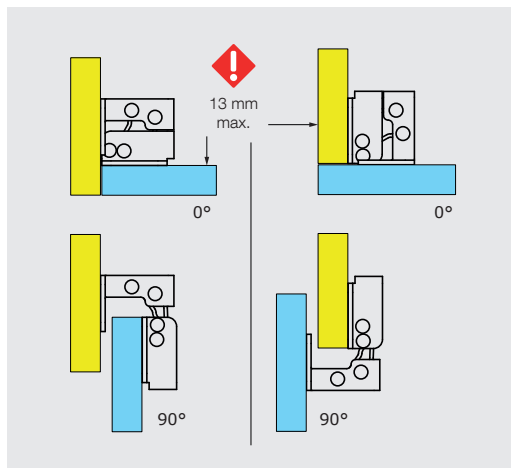
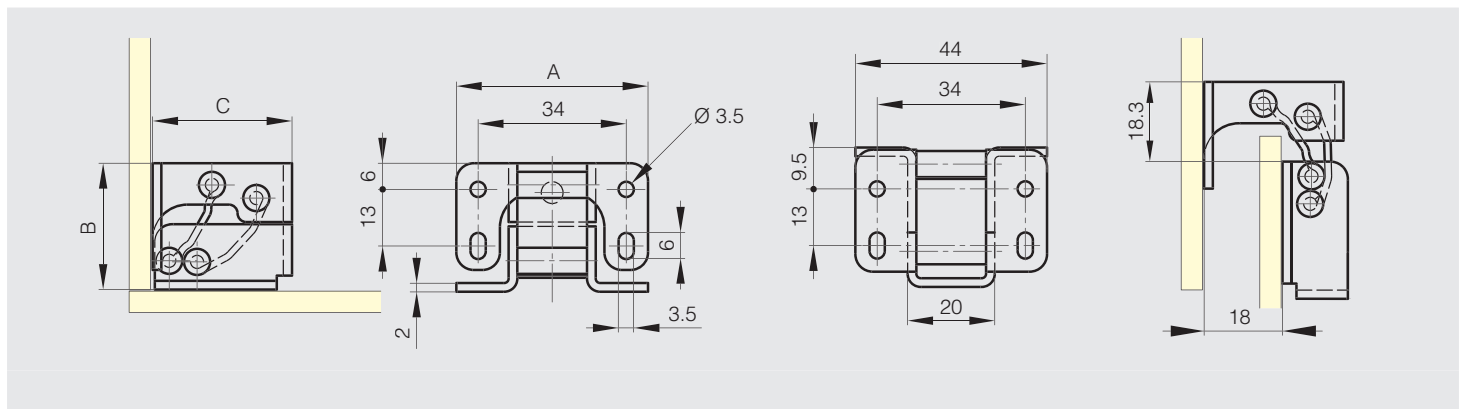

Nested door assembly shown

Surface mounted assembly shown

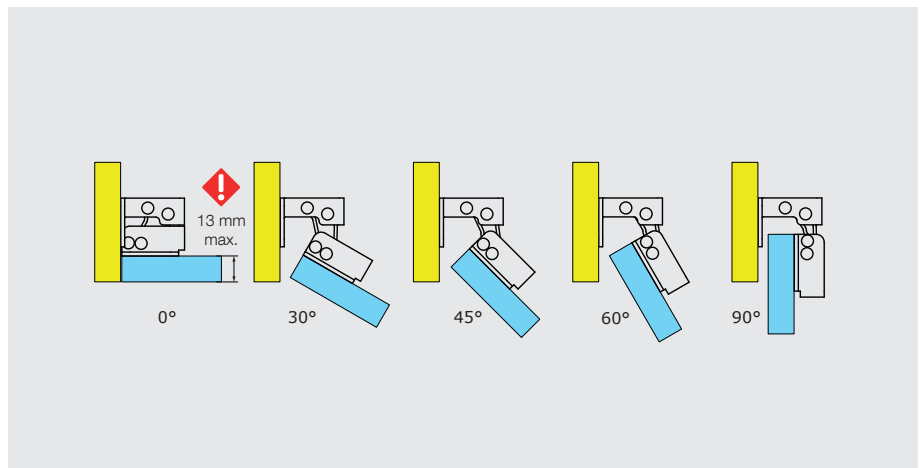

Nested door assembly shown

Concealed hinges

Concealed hinges for surface mounted doors or nested doors

Concealed hinges - 125° opening



Links in aluminium.

Pins in 430 stainless steel for 70-1-3639.

Pins in 304 Cu stainless steel for 70-1-3640.

Mounting features:

- For nested doors or surface mounted doors.
- LH or RH options.
- For horizontal or vertical applications.

Opening angle differs according to door thickness:

- 2 mm thickness: opening angle of 125°.
- 8 mm thickness: opening angle of 110°.
- 13 mm thickness: opening angle of 100°.

Please ask us for bespoke solutions.



	Part number	Material	Finish	A	B	C	Weight (g)
NEW	70-1-3639	steel	zinc plated	44	29	32	60
NEW	70-1-3640	316L stainless steel	raw	44	29	32	60

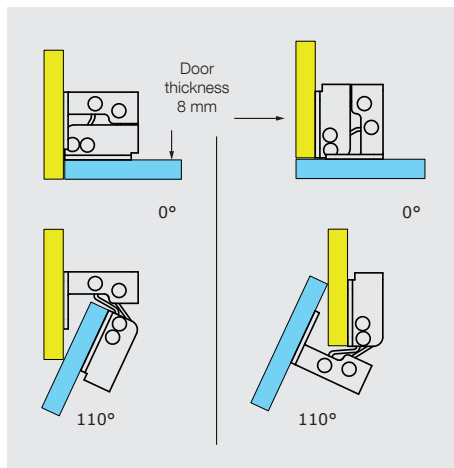
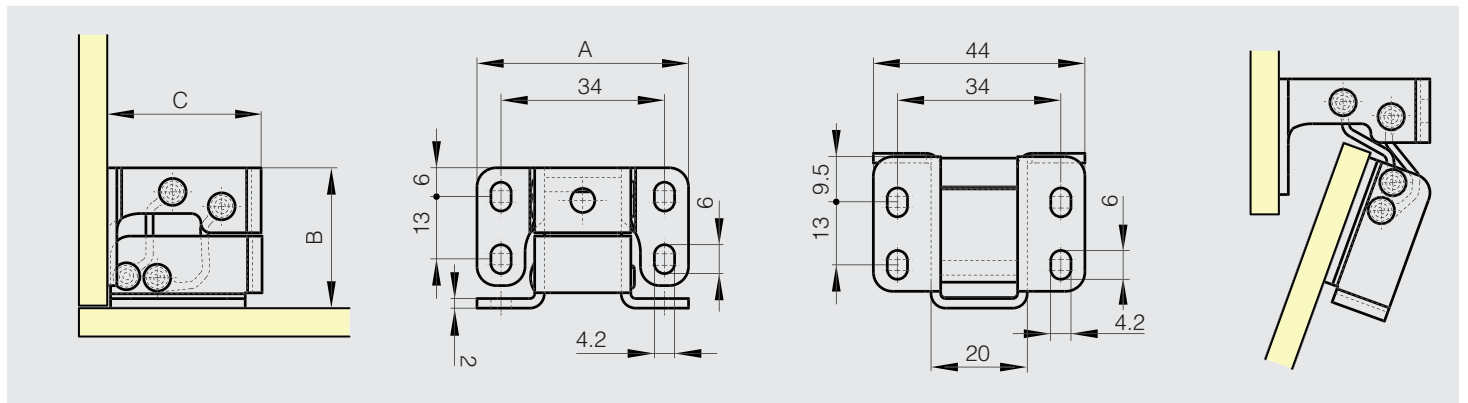

Nested door assembly shown

Surface mounted assembly shown

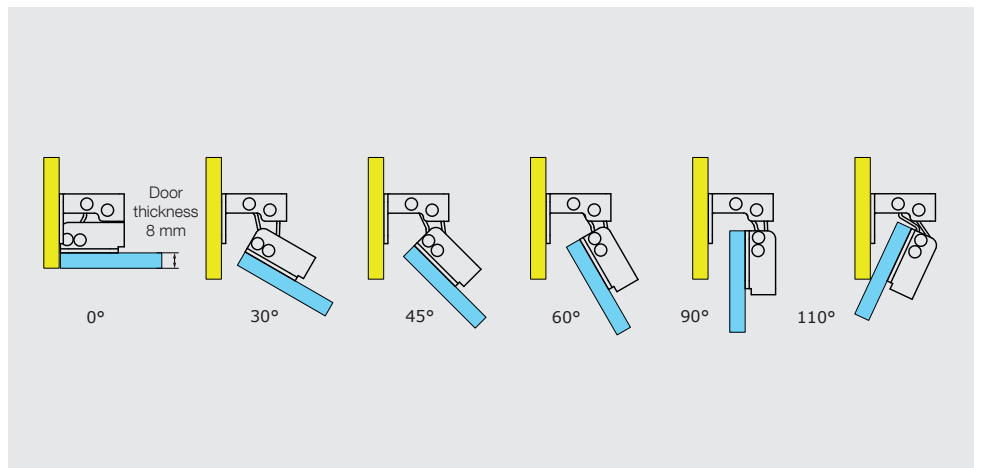

Nested door assembly shown

Concealed hinges

Concealed hinges for surface mounted doors or nested doors

Concealed hinge - 110° opening

Heavy duty concealed hinge.

Tested to 10,000 cycles using 2 hinges with a door weight of 25 kg measuring 1 m x 1 m.

Links in anodised aluminium.



Part number	Material	Finish	A	B	C	Weight (g)
70-1-3557	steel	zinc plated	102	80.5	76	520

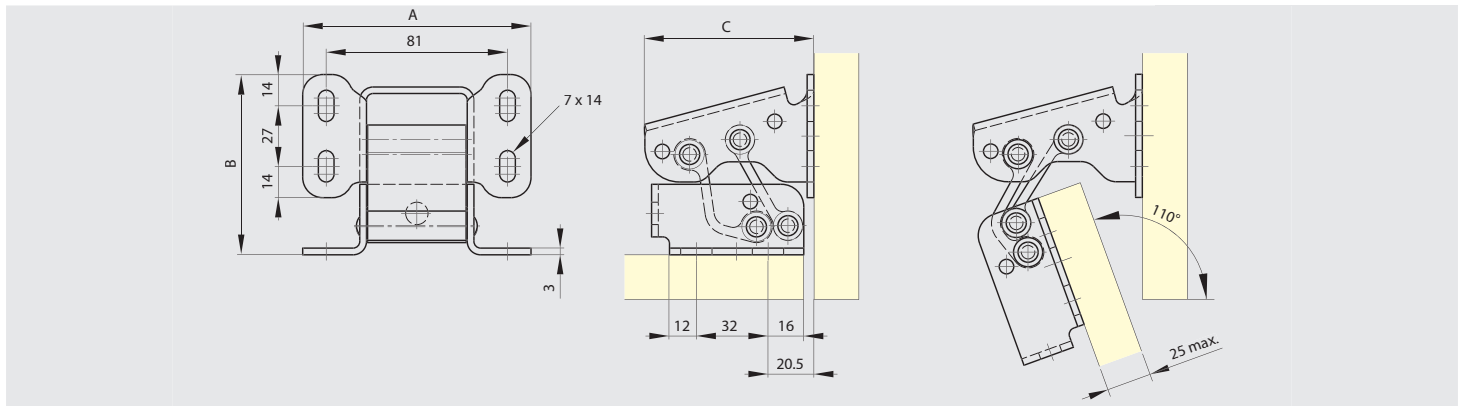

Spring loaded concealed hinge - 110° opening

For horizontal application only.

Fixing plate in polymer.



Part number	Material	Finish	A	B	C	Weight (g)
NEW 71-1-3611	steel	black zinc plated	60	162.4	71.4	132

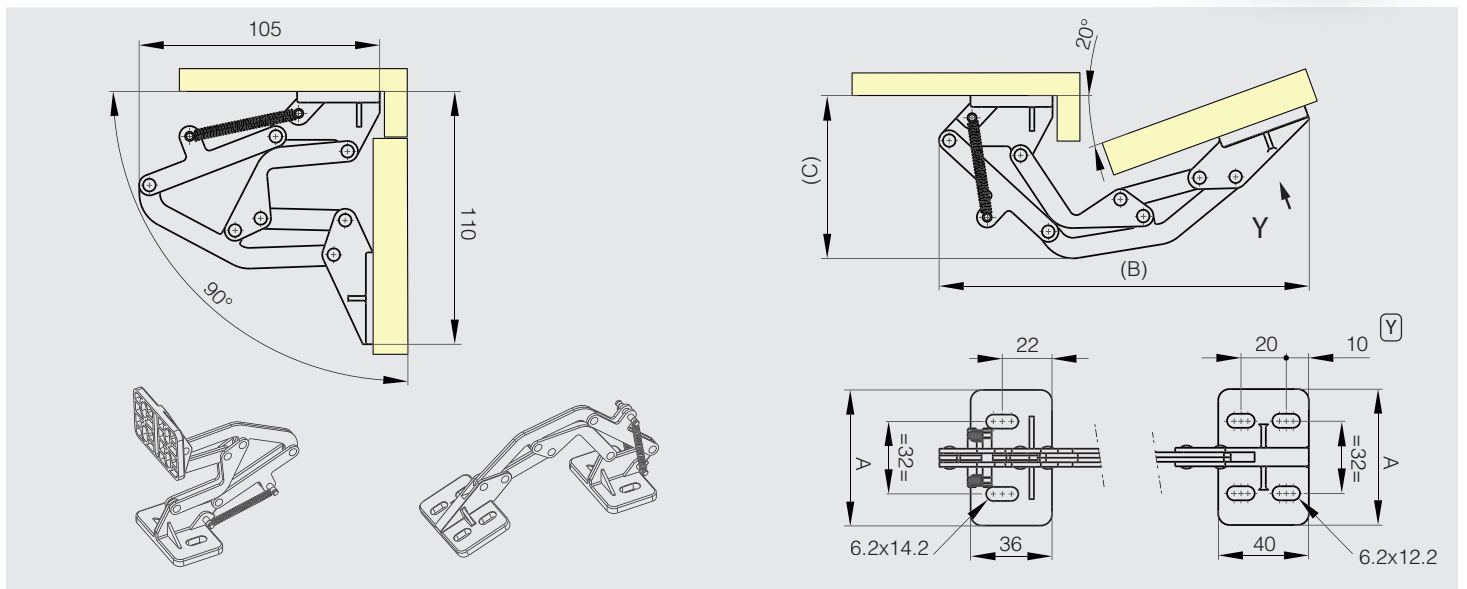

Spring loaded concealed hinges - 90° opening



Part number	Material	Finish	A	B	C	Weight (g)
70-1-9003	steel	nickel plated	44	104.5	26	70
70-1-9000	316 stainless steel	raw	44	104.5	26	70

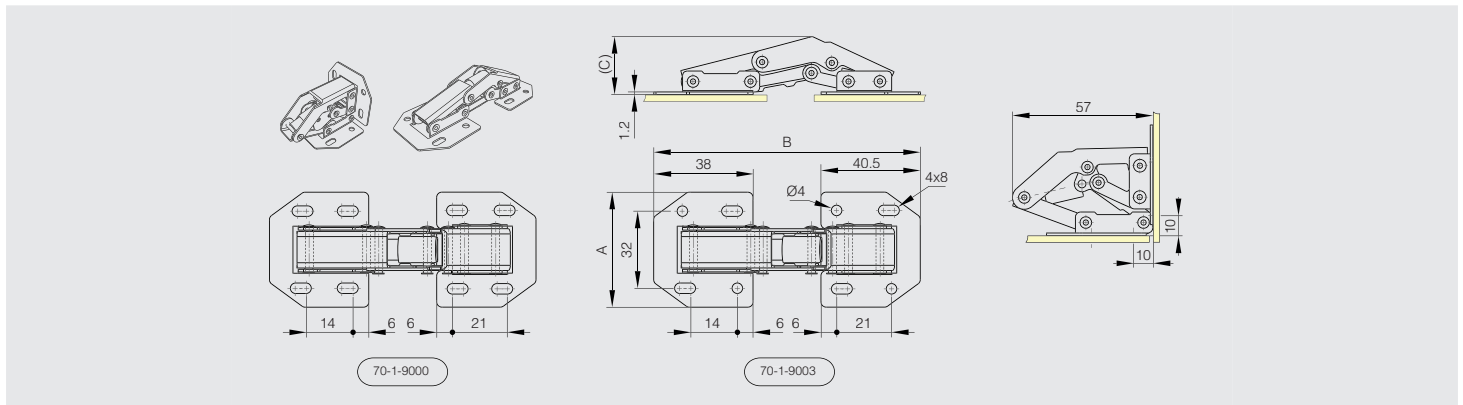
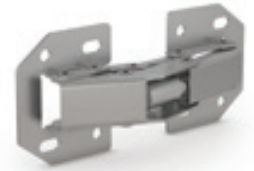

Spring loaded concealed hinges - 150° opening

For door thickness max: 20 mm.



Part number	Material	Finish	A	B	C	Weight (g)
70-1-9001	steel	nickel plated	52	121	73.5	140
70-1-9002	304 stainless steel	raw	52	121	73.5	140

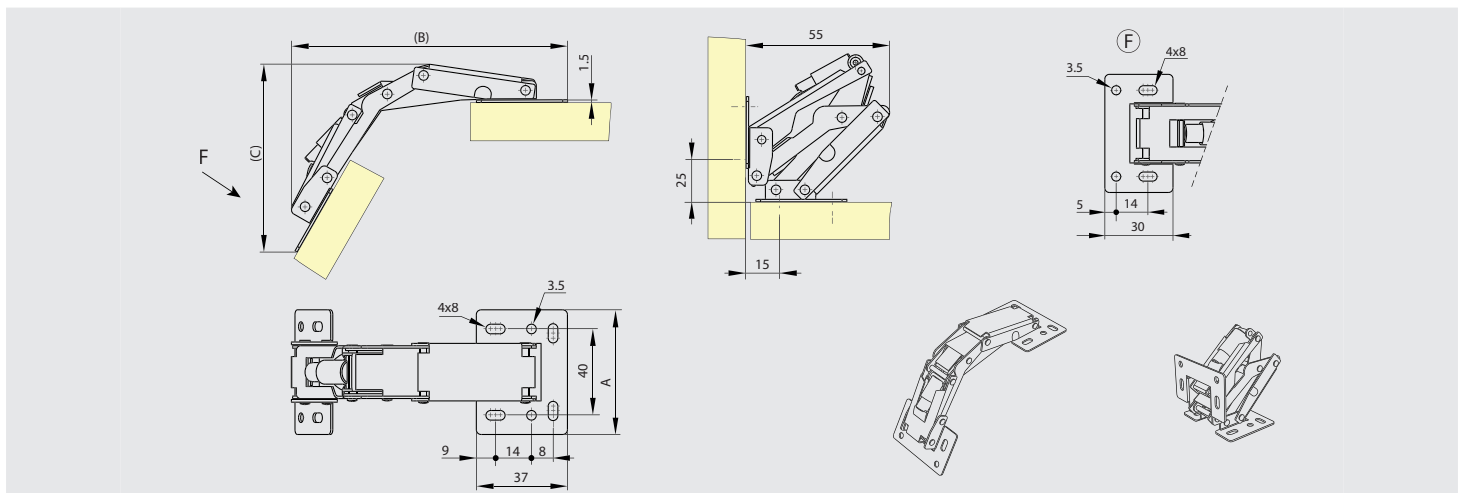

Concealed hinges

Concealed hinges for surface mounted doors or nested doors

Concealed hinges with two cranked leaves - undrilled - 120° opening - version A

Hinges for side door of baggage compartment (bus and coach, bodywork...)



	Part number	Material	Finish	A	B	C	D	E	Weight (g)
NEW	39-1-3885	304 stainless steel	raw	300	44.1	1.5	3	12.5	440
NEW	39-1-3887	304 stainless steel	raw	600	44.1	1.5	3	12.5	880

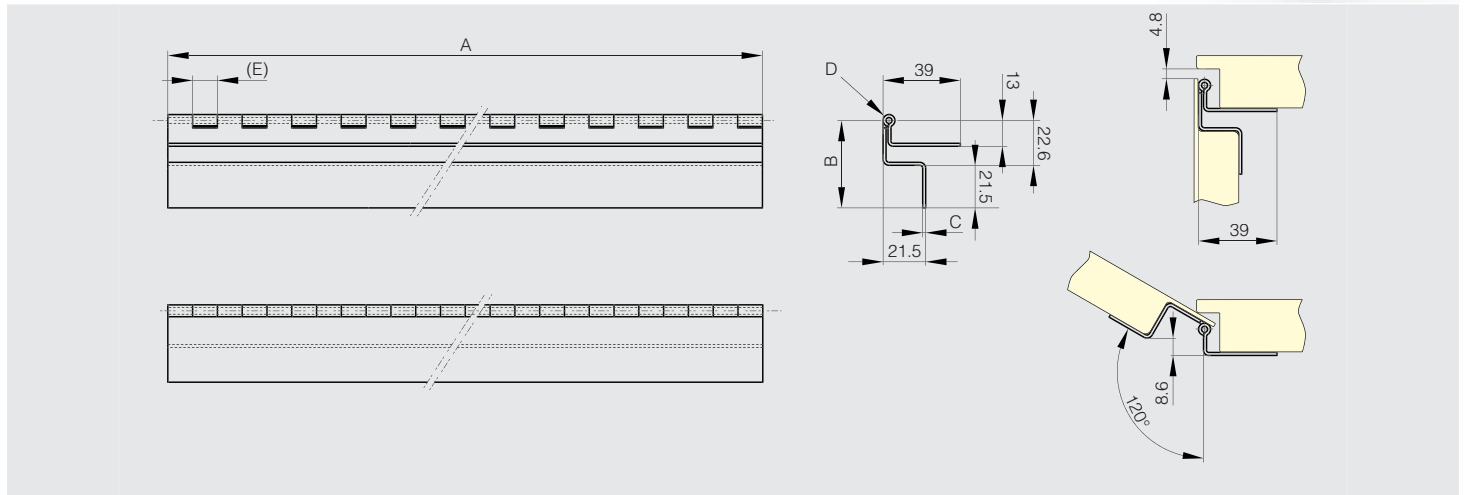

Concealed hinges with two cranked leaves - drilled - 120° opening - version A

Hinges for side door of baggage compartment (bus and coach, bodywork...)

Use rivets for 4.2 diameter holes (door side).

Use self-drilling screws for 12.2 diameter holes (frame side).



	Part number	Material	Finish	A	B	C	D	E	G	H	Weight (g)
NEW	39-1-3886	304 stainless steel	raw	300	44.1	1.5	3	12.5	160	70	430
NEW	39-1-3888	304 stainless steel	raw	600	44.1	1.5	3	12.5	160	60	870

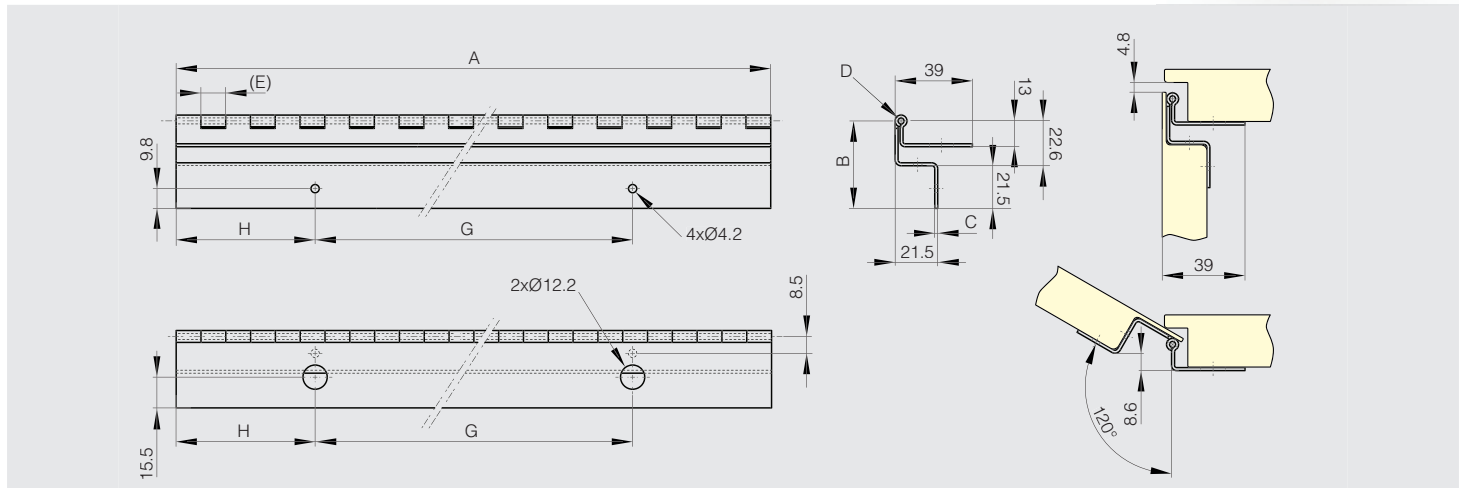

FIXOR^{SL}

Calle del Dr. Mata num 5, 08203 Sabadell
Tel 93 710 41 60, tecnica@fixor.es
www.fixor.es

Concealed hinges

Concealed hinges for surface mounted doors or nested doors

Concealed hinges with two cranked leaves - undrilled - 120° opening - version B

Hinges for side door of baggage compartment (bus and coach, bodywork...)



Part number	Material	Finish	A	B	C	D	E	Weight (g)
NEW 39-1-3889	304 stainless steel	raw	300	54.1	1.5	3	12.5	410
NEW 39-1-3891	304 stainless steel	raw	600	54.1	1.5	3	12.5	870

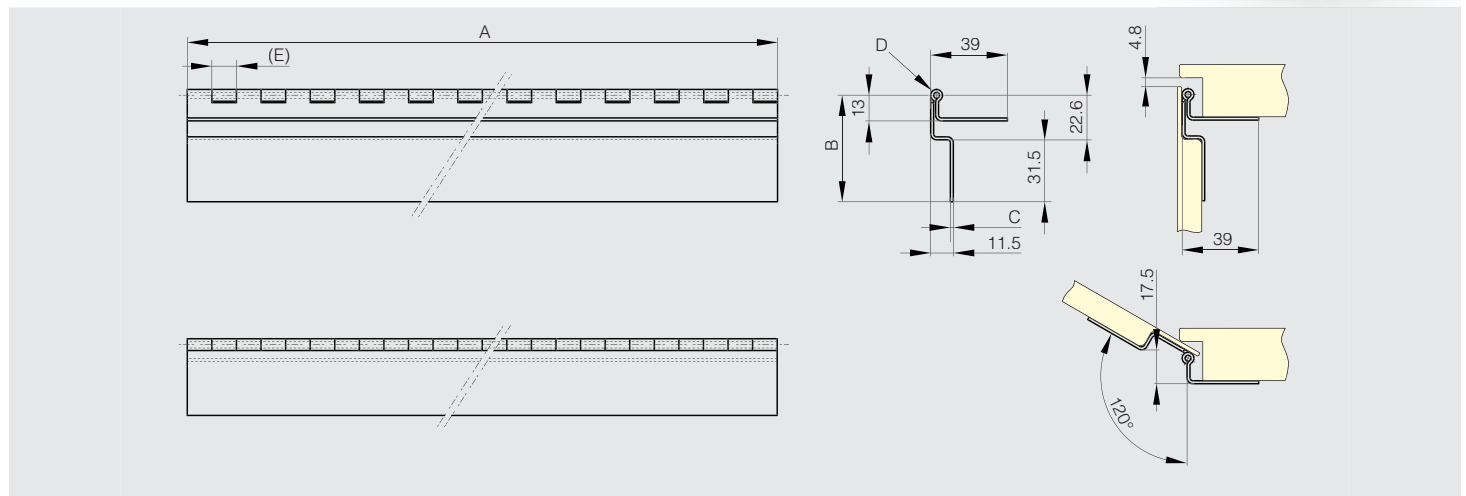

Concealed hinges with two cranked leaves - drilled - 120° opening - version B

Hinges for side door of baggage compartment (bus and coach, bodywork...)

Use rivets for 4.2 diameter holes (door side).

Use self-drilling screws for 12.2 diameter holes (frame side).



Part number	Material	Finish	A	B	C	D	E	G	H	J	K	L	Weight (g)
NEW 39-1-3890	304 stainless steel	raw	300	54.1	1.5	3	12.5	160	30	80	70	160	430
NEW 39-1-3892	304 stainless steel	raw	600	54.1	1.5	3	12.5	260	40	130	60	160	870

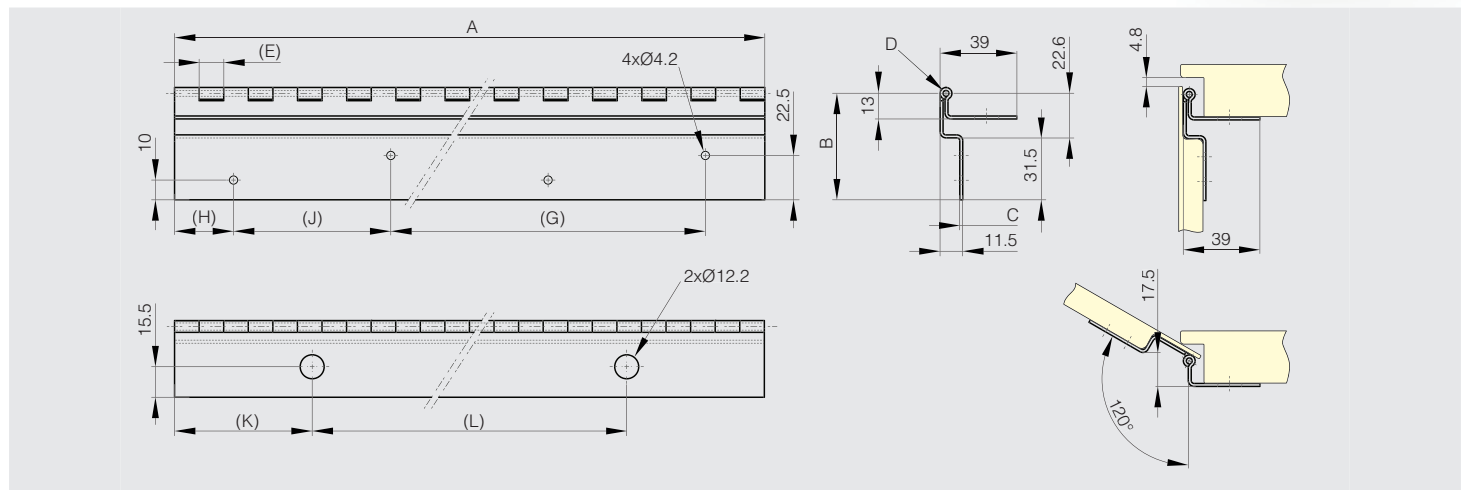

FIXORS_{SL}

Calle del Dr. Mata num 5, 08203 Sabadell
Tel 93 710 41 60, tecnica@fixores.com
www.fixores.com

www.pinetuk.com

PINET